

快插接头 Quick Connector

JL-1001



Size: $\Phi 4$ $\Phi 6$
 $\Phi 8$ $\Phi 10$
 $\Phi 12$ $\Phi 14$
 $\Phi 16$

JL-1002



Size: $\Phi 4$ $\Phi 6$
 $\Phi 8$ $\Phi 10$
 $\Phi 12$ $\Phi 14$
 $\Phi 16$

JL-1003



Size: $\Phi 4$ $\Phi 6$
 $\Phi 8$ $\Phi 10$
 $\Phi 12$ $\Phi 14$
 $\Phi 16$

JL-1004



Size: $\Phi 4$ $\Phi 6$
 $\Phi 8$ $\Phi 10$
 $\Phi 12$ $\Phi 14$
 $\Phi 16$

JL-1005



Size: $\Phi 4$ $\Phi 6$
 $\Phi 8$ $\Phi 10$
 $\Phi 12$ $\Phi 14$
 $\Phi 16$

JL-1006



Size: $\Phi 4$ $\Phi 6$
 $\Phi 8$ $\Phi 10$
 $\Phi 12$ $\Phi 14$
 $\Phi 16$

JL-1007

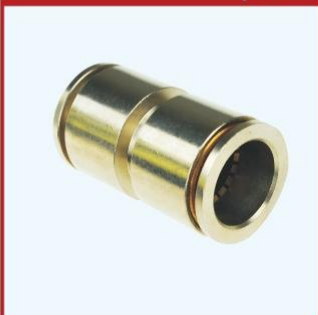

Size: $\Phi 4$ $\Phi 6$
 $\Phi 8$ $\Phi 10$
 $\Phi 12$ $\Phi 14$
 $\Phi 16$

JL-1008



Size: $\Phi 4$ $\Phi 6$
 $\Phi 8$ $\Phi 10$
 $\Phi 12$ $\Phi 14$
 $\Phi 16$

快插接头 Quick Connector

JL-1009



Size: $\Phi 4$ $\Phi 6$
 $\Phi 8$ $\Phi 10$
 $\Phi 12$ $\Phi 14$
 $\Phi 16$

JL-1010



Size: TPG8-4
TPG10-6
TPG12-8
TPG16-12
TPG6-4
TPG8-6
TPG10-8
TPG12-10

JL-1011



Size: TPEG-T6-4
TPEG-T8-6
TPEG-T10-8
TPEG-T12-10
TPEG-T8-4
TPEG-T10-6
TPEG-T12-8

JL-1012



Size: TPW-Y6-4
TPW-Y8-6
TPW-Y10-8
TPW-Y12-10
TPW-Y 10-6
TPW-Y 12-8

JL-1013



Size: 6-01 10-01
6-02 10-02
6-03 10-03
6-04 10-04
8-01 12-01
8-02 12-02
8-03 12-03
8-04 12-04

JL-1014



Size: 6-01 10-01
6-02 10-02
6-03 10-03
6-04 10-04
8-01 12-01
8-02 12-02
8-03 12-03
8-04 12-04

JL-1015



Size: 6-01 10-01
6-02 10-02
6-03 10-03
6-04 10-04
8-01 12-01
8-02 12-02
8-03 12-03
8-04 12-04

JL-1016



Size: $\Phi 4$
 $\Phi 6$
 $\Phi 8$
 $\Phi 10$
 $\Phi 12$

快插接头 Quick Connector

JL-1017



Size

EPB4-M5	EPB8-04
EPB4-01	EPB10-01
EPB4-02	EPB10-02
EPB6-M5	EPB10-03
EPB6-01	EPB10-04
EPB6-02	EPB12-01
EPB6-03	EPB12-02
EPB6-04	EPB12-03
EPB8-01	EPB12-04
EPB8-02	EPB16-03
EPB8-03	EPB16-04

JL-1018



Size

EPD4-M5	EPD8-04
EPD4-01	EPD10-01
EPD4-02	EPD10-02
EPD6-M5	EPD10-03
EPD6-01	EPD10-04
EPD6-02	EPD12-01
EPD6-03	EPD12-02
EPD6-04	EPD12-03
EPD8-01	EPD12-04
EPD8-02	EPD16-03
EPD8-03	EPD16-04

JL-1019



Size

EPL4-M5	EPL8-04
EPL4-01	EPL10-01
EPL4-02	EPL10-02
EPL6-M5	EPL10-03
EPL6-01	EPL10-04
EPL6-02	EPL12-01
EPL6-03	EPL12-02
EPL6-04	EPL12-03
EPL8-01	EPL12-04
EPL8-02	EPL16-03
EPL8-03	EPL16-04

JL-1020



Size

EPC4-M5	EPC8-04
EPC4-01	EPC10-01
EPC4-02	EPC10-02
EPC6-M5	EPC10-03
EPC6-01	EPC10-04
EPC6-02	EPC12-01
EPC6-03	EPC12-02
EPC6-04	EPC12-03
EPC8-01	EPC12-04
EPC8-02	EPC16-03
EPC8-03	EPC16-04

快插接头 Quick Connector

JL-1021



Size: TPZA4
TPZA6
TPZA8
TPZA10
TPZA12

JL-1022



Size: TPK4
TPK6
TPK8
TPK10
TPK12

JL-1023



Size: $\Phi 4$ $\Phi 6$
 $\Phi 8$ $\Phi 10$
 $\Phi 12$

JL-1024



Size: $\Phi 4$ $\Phi 6$
 $\Phi 8$ $\Phi 10$
 $\Phi 12$

JL-1025



Size: $\Phi 4$ $\Phi 6$
 $\Phi 8$ $\Phi 10$
 $\Phi 12$

JL-1026



Size: $\Phi 4$ $\Phi 6$
 $\Phi 8$ $\Phi 10$
 $\Phi 12$

JL-1027



Size: 6-01 10-01
6-02 10-02
6-03 10-03
6-04 10-04
8-01 12-01
8-02 12-02
8-03 12-03
8-04 12-04

JL-1028



Size: 6-01 10-01
6-02 10-02
6-03 10-03
6-04 10-04
8-01 12-01
8-02 12-02
8-03 12-03
8-04 12-04

制动皮碗 Brake diaphragm

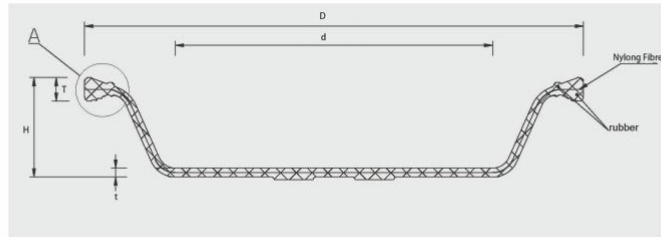

JL-2001

T₃₆



Size: $\Phi 215$

JL-2002

T₃₀



Size: $\Phi 199$

JL-2003

T_{30L}



Size: $\Phi 200$

JL-2004

T₂₇



Size: $\Phi 189$

JL-2005

T_{27L}



Size: $\Phi 189$

JL-2006

T₂₄



Size: $\Phi 179$

制动皮碗 Brake diaphragm

JL-2007

T_{24L}



Size: Φ 179

JL-2008

T₂₀



Size: Φ 168

JL-2009

T_{20L}



Size: Φ 168

JL-2010

T₁₆



Size: Φ 156

JL-2011

T_{16L}



Size: Φ 157

JL-2012

T₁₂



Size: Φ 135

JL-2013

T_{12L}



Size: Φ 135

JL-2014

T₉



Size: Φ 129

铜接头 Brass Connector

JL-3001



Size

M10 × 1mm	D 6 × 1mm
M10 × 1mm	D 8 × 1mm
M10 × 1mm	D 10 × 1mm
M10 × 1mm	D 12 × 1.5mm
M12 × 1.5mm	D 6 × 1mm
M12 × 1.5mm	D 8 × 1mm
M12 × 1.5mm	D 9 × 1mm
M12 × 1.5mm	D 10 × 1mm
M12 × 1.5mm	D 12 × 1.5mm
M12 × 1.5mm	D 14 × 1.5mm
M14 × 1.5mm	D 6 × 1mm
M14 × 1.5mm	D 8 × 1mm
M14 × 1.5mm	D 10 × 1mm
M14 × 1.5mm	D 12 × 1.5mm
M16 × 1.5mm	D 6 × 1mm
M16 × 1.5mm	D 8 × 1mm
M16 × 1.5mm	D 9 × 1mm
M16 × 1.5mm	D 10 × 1mm
M16 × 1.5mm	D 10 × 1.5mm
M16 × 1.5mm	D 12 × 1.5mm
M16 × 1.5mm	D 14 × 1.5mm
M16 × 1.5mm	D 15 × 1.5mm
M16 × 1.5mm	D 16 × 2mm
M22 × 1.5mm	D 6 × 1mm
M22 × 1.5mm	D 8 × 1mm
M22 × 1.5mm	D 9 × 1mm
M22 × 1.5mm	D 10 × 1mm
M22 × 1.5mm	D 10 × 1.5mm
M22 × 1.5mm	D 12 × 1.5mm
M22 × 1.5mm	D 14 × 1.5mm
M22 × 1.5mm	D 15 × 1.5mm
M22 × 1.5mm	D 16 × 2mm

JL-3002



Size

M10 × 1mm	D 6 × 1mm
M10 × 1mm	D 8 × 1mm
M10 × 1mm	D 10 × 1mm
M10 × 1mm	D 12 × 1.5mm
M10 × 1mm	D 15 × 1.5mm
M10 × 1mm	D 16 × 2mm
M12 × 1.5mm	D 6 × 1mm
M12 × 1.5mm	D 8 × 1mm
M12 × 1.5mm	D 10 × 1mm
M12 × 1.5mm	D 12 × 1.5mm
M12 × 1.5mm	D 15 × 1.5mm
M12 × 1.5mm	D 16 × 2mm
M14 × 1.5mm	D 6 × 1mm
M14 × 1.5mm	D 8 × 1mm
M14 × 1.5mm	D 10 × 1mm
M14 × 1.5mm	D 12 × 1.5mm
M14 × 1.5mm	D 15 × 1.5mm
M14 × 1.5mm	D 16 × 2mm
M16 × 1.5mm	D 6 × 1mm
M16 × 1.5mm	D 8 × 1mm
M16 × 1.5mm	D 10 × 1mm
M16 × 1.5mm	D 12 × 1.5mm
M16 × 1.5mm	D 15 × 1.5mm
M16 × 1.5mm	D 16 × 2mm
M22 × 1.5mm	D 6 × 1mm
M22 × 1.5mm	D 8 × 1mm
M22 × 1.5mm	D 10 × 1mm
M22 × 1.5mm	D 12 × 1.5mm
M22 × 1.5mm	D 15 × 1.5mm
M22 × 1.5mm	D 16 × 2mm

JL-3003



Size

D 6 × 1mm	D 10 × 1.5mm
D 8 × 1mm	D 12 × 1.5mm
D 9 × 1mm	D 14 × 1.5mm
D 10 × 1mm	D 15 × 1.5mm
	D 16 × 2mm

JL-3004



Size

M12 × 1.5mm	D 6 × 1mm	M16 × 1.5mm	D 10 × 1mm
M12 × 1.5mm	D 8 × 1mm	M16 × 1.5mm	D 12 × 1.5mm
M12 × 1.5mm	D 10 × 1mm	M22 × 1.5mm	D 6 × 1mm
M12 × 1.5mm	D 12 × 1.5mm	M22 × 1.5mm	D 8 × 1mm
M16 × 1.5mm	D 6 × 1mm	M22 × 1.5mm	D 10 × 1mm
M16 × 1.5mm	D 8 × 1mm	M22 × 1.5mm	D 12 × 1.5mm

铜接头 Brass Connector

JL-3005



Size

6 × 6	10 × 10
8 × 8	12 × 12

JL-3006



Size

6 × 6 × 6	10 × 10 × 10
8 × 8 × 8	12 × 12 × 12

JL-3007



Size

M10 × 1.5mm	D 6 × 1mm	M14 × 1.5mm	D 12 × 1.5mm
M10 × 1.5mm	D 8 × 1mm	M16 × 1.5mm	D 6 × 1mm
M10 × 1.5mm	D 10 × 1mm	M16 × 1.5mm	D 8 × 1mm
M10 × 1.5mm	D 12 × 1.5mm	M16 × 1.5mm	D 10 × 1mm
M12 × 1.5mm	D 6 × 1mm	M16 × 1.5mm	D 12 × 1.5mm
M12 × 1.5mm	D 8 × 1mm	M16 × 1.5mm	D 16 × 2mm
M12 × 1.5mm	D 10 × 1mm	M22 × 1.5mm	D 6 × 1mm
M12 × 1.5mm	D 12 × 1.5mm	M22 × 1.5mm	D 8 × 1mm
M12 × 1.5mm	D 16 × 2mm	M22 × 1.5mm	D 10 × 1mm
M14 × 1.5mm	D 6 × 1mm	M22 × 1.5mm	D 12 × 1.5mm
M14 × 1.5mm	D 8 × 1mm	M22 × 1.5mm	D 16 × 2mm
M14 × 1.5mm	D 10 × 1mm		

JL-3008



Size

M10 × 1mm	D 6 × 1mm	M16 × 1.5mm	D 9 × 1mm
M10 × 1mm	D 8 × 1mm	M16 × 1.5mm	D 10 × 1mm
M10 × 1mm	D 10 × 1mm	M16 × 1.5mm	D 10 × 1.5mm
M10 × 1mm	D 12 × 1.5mm	M16 × 1.5mm	D 12 × 1.5mm
M12 × 1.5mm	D 6 × 1mm	M16 × 1.5mm	D 14 × 1.5mm
M12 × 1.5mm	D 8 × 1mm	M16 × 1.5mm	D 15 × 1.5mm
M12 × 1.5mm	D 9 × 1mm	M16 × 1.5mm	D 16 × 2mm
M12 × 1.5mm	D 10 × 1mm	M22 × 1.5mm	D 6 × 1mm
M12 × 1.5mm	D 12 × 1.5mm	M22 × 1.5mm	D 8 × 1mm
M12 × 1.5mm	D 14 × 1.5mm	M22 × 1.5mm	D 9 × 1mm
M14 × 1.5mm	D 6 × 1mm	M22 × 1.5mm	D 10 × 1mm
M14 × 1.5mm	D 8 × 1mm	M22 × 1.5mm	D 10 × 1.5mm
M14 × 1.5mm	D 10 × 1mm	M22 × 1.5mm	D 12 × 1.5mm
M14 × 1.5mm	D 12 × 1.5mm	M22 × 1.5mm	D 14 × 1.5mm
M16 × 1.5mm	D 6 × 1mm	M22 × 1.5mm	D 15 × 1.5mm
M16 × 1.5mm	D 8 × 1mm	M22 × 1.5mm	D 16 × 2mm

JL-3009



Size Φ 6
 Φ 8
 Φ 10
 Φ 12

JL-3010



Size M16
M22

铜接头 Brass Connector

JL-3011



Size

6 x 6-12 x 1.5	10 x 10-12 x 1.5
6 x 6-16 x 1.5	10 x 10-16 x 1.5
6 x 6-22 x 1.5	10 x 10-22 x 1.5
8 x 8-12 x 1.5	12 x 12-12 x 1.5
8 x 8-16 x 1.5	12 x 12-16 x 1.5
8 x 8-22 x 1.5	12 x 12-22 x 1.5

JL-3012



Size

F12 x 1.5-F12 x 1.5-P5
F14 x 1.5-F14 x 1.5-P5
F16 x 1.5-F16 x 1.5-P5
F22 x 1.5-F22 x 1.5-P5

JL-3013



Size

P5 M10 x 1
P5 M12 x 1.5
P5 M14 x 1.5
P5 M16 x 1.5
P5 M22 x 1.5

JL-3014



Size

P5 D6 x 1mm
P5 D8 x 1mm
P5 D10 x 1mm
P5 D12 x 1.5mm
P5 D15 x 1.5mm
P5 D16 x 2mm

JL-3015



Size

M12 x 1.5mm	F16 x 1.5mm
M12 x 1.5mm	F22 x 1.5mm
M14 x 1.5mm	F16 x 1.5mm
M16 x 1.5mm	F12 x 1.5mm
M16 x 1.5mm	F22 x 1.5mm
M22 x 1.5mm	F12 x 1.5mm
M22 x 1.5mm	F16 x 1.5mm

JL-3016



Size

M10 x 1mm
M12 x 1.5mm
M16 x 1.5mm
M22 x 1.5mm

铜接头 Brass Connector

JL-3017



Size

P5 M12×1.5	P5 M16×1.5
P5 M14×1.5	M16×1.5×3

JL-3018



Size

P5 M12×1.5	M16×1.5–M16×1.5
P5 M14×1.5	M22×1.5–M22×1.5
P5 M16×1.5	

JL-3019



Size

P5 M12×1.5	P5 M16×1.5
P5 M14×1.5	M16×1.5–M16×1.5

JL-3020



Size

P5 M12×1.5	P5 M16×1.5
P5 M14×1.5	M16×1.5×3

JL-3021



Size

F12×1.5–F12×1.5–M16×1.5
F16×1.5–F16×1.5–M16×1.5
F16×1.5–F16×1.5–M12×1.5
F16×1.5–F16×1.5–M22×1.5

JL-3022



Size

D6–F12×1.5	D8–F12×1.5	D10–F12×1.5	D12–F12×1.5
D6–F16×1.5	D8–F16×1.5	D10–F16×1.5	D12–F16×1.5
D6–F18×1.5	D8–F18×1.5	D10–F18×1.5	D12–F18×1.5
D6–F22×1.5	D8–F22×1.5	D10–F22×1.5	D12–F22×1.5

铜接头 Brass Connector

JL-3023



Size

M10 × 1mm
M12 × 1.5mm
M12 × 1.5mm
M14 × 1.5mm
M16 × 1.5mm
M16 × 1.5mm
M22 × 1.5mm
M22 × 1.5mm

F16 × 1.5mm
F12 × 1.5mm
F16 × 1.5mm
F16 × 1.5mm
F12 × 1.5mm
F16 × 1.5mm
F16 × 1.5mm
F22 × 1.5mm

JL-3024



Size

D6-F12*1.5
D6-F16*1.5
D6-F18*1.5
D6-F22*1.5
D8-F12*1.5
D8-F16*1.5
D8-F18*1.5
D8-F22*1.5

D10-F12*1.5
D10-F16*1.5
D10-F18*1.5
D10-F22*1.5
D12-F12*1.5
D12-F16*1.5
D12-F18*1.5
D12-F22*1.5

JL-3025



Size

D6-M12 × 1.5
D6-M16 × 1.5
D6-M18 × 1.5
D6-M22 × 1.5
D8-M12 × 1.5
D8-M16 × 1.5
D8-M18 × 1.5
D8-M22 × 1.5

D10-M12 × 1.5
D10-M16 × 1.5
D10-M18 × 1.5
D10-M22 × 1.5
D12-M12 × 1.5
D12-M16 × 1.5
D12-M18 × 1.5
D12-M22 × 1.5

JL-3026



Size

M12 × 1.5-M16 × 1.5
M10 × 1.5-M22 × 1.5
M16 × 1.5-M16 × 1.5
M16 × 1.5-M22 × 1.5
M22 × 1.5-M22 × 1.5

JL-3027



Size

M16 × 1.5 D6
M16 × 1.5 D8
M16 × 1.5 D10
M16 × 1.5 D12
M22 × 1.5 D6
M22 × 1.5 D8
M22 × 1.5 D10
M22 × 1.5 D12

JL-3028



铜接头 Brass Connector

JL-3029



Size

M12 × 1.5mm	D 6 × 1mm
M12 × 1.5mm	D 8 × 1mm
M12 × 1.5mm	D10 × 1mm
M12 × 1.5mm	D 12 × 1.5mm
M16 × 1.5mm	D 6 × 1mm
M16 × 1.5mm	D 8 × 1mm
M16 × 1.5mm	D10 × 1mm
M16 × 1.5mm	D 12 × 1.5mm
M22 × 1.5mm	D 6 × 1mm
M22 × 1.5mm	D 8 × 1mm
M22 × 1.5mm	D10 × 1mm
M22 × 1.5mm	D 12 × 1.5mm

JL-3030



Size

M12 × 1.5mm	D 6 × 1mm
M12 × 1.5mm	D 8 × 1mm
M12 × 1.5mm	D10 × 1mm
M12 × 1.5mm	D 12 × 1.5mm
M16 × 1.5mm	D 6 × 1mm
M16 × 1.5mm	D 8 × 1mm
M16 × 1.5mm	D10 × 1mm
M16 × 1.5mm	D 12 × 1.5mm
M22 × 1.5mm	D 6 × 1mm
M22 × 1.5mm	D 8 × 1mm
M22 × 1.5mm	D10 × 1mm
M22 × 1.5mm	D 12 × 1.5mm

JL-3031



Size

M10 × 1mm	D 6 × 1	M12 × 1.5mm	D 12 × 1.5	M16 × 1.5mm	D 9 × 1	M22 × 1.5mm	D 8 × 1
M10 × 1mm	D 8 × 1	M12 × 1.5mm	D 14 × 1.5	M16 × 1.5mm	D10 × 1	M22 × 1.5mm	D 9 × 1
M10 × 1mm	D 10 × 1	M14 × 1.5mm	D 6 × 1	M16 × 1.5mm	D 10 × 1.5	M22 × 1.5mm	D10 × 1
M10 × 1mm	D12 × 1.5	M14 × 1.5mm	D 8 × 1	M16 × 1.5mm	D 12 × 1.5	M22 × 1.5mm	D 10 × 1.5
M12 × 1.5mm	D 6 × 1	M14 × 1.5mm	D10 × 1	M16 × 1.5mm	D 14 × 1.5	M22 × 1.5mm	D 12 × 1.5
M12 × 1.5mm	D 8 × 1	M14 × 1.5mm	D12 × 1.5	M16 × 1.5mm	D 15 × 1.5	M22 × 1.5mm	D 14 × 1.5
M12 × 1.5mm	D 9 × 1	M16 × 1.5mm	D 6 × 1	M16 × 1.5mm	D 16 × 2	M22 × 1.5mm	D 15 × 1.5
M12 × 1.5mm	D10 × 1	M16 × 1.5mm	D 8 × 1	M22 × 1.5mm	D 6 × 1	M22 × 1.5mm	D 16 × 2

JL-3032



Size

D 6 × 1mm
D 8 × 1mm
D10 × 1mm
D 12 × 1.5mm
D 15 × 1.5mm
D 16 × 2mm

JL-3033



Size

D 6 × 1mm
D 8 × 1mm
D10 × 1mm
D 12 × 1.5mm

铜接头 Brass Connector

JL-3034



Size

D 6 × 1mm
D 8 × 1mm
D 10 × 1mm
D 12 × 1.5mm
D 15 × 1.5mm
D 16 × 2mm

JL-3035



Size

D 6 × 1mm
D 8 × 1mm
D 10 × 1mm
D 12 × 1.5mm
D 15 × 1.5mm
D 16 × 2mm

JL-3036



Size

16-20
16-22
18-20
18-22
20-22

JL-3037



Size

14-1/8
14-10
14-14
16-14
16-3/8
16-16

JL-3038



JL-3039



Size

14-12
12-12
16-12
16-14
16-16

JL-3040



Size

10-10-10
10-1/8-10
12-12-12
14-14-14
16-16-16
18-18-18

JL-3041



Size

10-1/8
14-1/8
10-10
12-10
14-10
14-14
16-3/8
18-3/8

铜接头 Brass Fitting

JL-3042



Size:

16-18-16
16-20-16
16-22-16
18-20-18
18-22-18

JL-3043



Size:

14-12
12-12
16-12
16-14
16-16

JL-3044



Size:

16-20
16-22
18-20
18-22
20-22

JL-3045



Size:

12-10
12-12
14-10
14-12

JL-3046



Size:

14-12
12-12
16-12
16-14
16-16

JL-3047



Size:

F12 × 1.5
M16 × 1.5
M22 × 1.5

JL-3048



Size:

1/4 3/8
1/2

JL-3049



Size:

22*1.5
1/2

铜接头 Brass Connector

JL-3050



Size: 15-1/4NPT
15-12×1.5
15-16×1.5
15-22×1.5
17-1/8-27NPT
17-3/8-18NPT
17-M16×1.5
17-M22×1.5
20-M16×1.5
20-M22×1.5

JL-3051



Size: 1/4
1/8
3/8
3/4
1/2

JL-3052

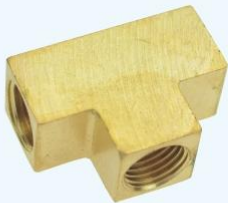

Size: 1/4
1/8
3/8
3/4
1/2

JL-3053



Size: 1/4
1/8
3/8
3/4
1/2

JL-3054



Size: 1/4
1/8
3/8
3/4
1/2

JL-3055



Size:

JL-3056



Size:

JL-3057



Size: 4×4
6×6
8×8
10×10
12×12
1/4×1/4
3/8×3/8
1/2×1/2
5/8×5/8

铜接头 Brass Fitting

JL-3058



Size: 16-M6
16-M8
16-M10
16-M12
22-M6
22-M8
22-M10
22-M12

JL-3059



Size: 16-M6
16-M8
16-M10
16-M12
22-M6
22-M8
22-M10
22-M12

JL-3060



Size: 16-M6
16-M8
16-M10
16-M12
22-M6
22-M8
22-M10
22-M12

JL-3061



Size: 16-M6
16-M8
16-M10
16-M12
22-M6
22-M8
22-M10
22-M12

JL-3062



Size: $\Phi 6$
 $\Phi 8$
 $\Phi 10$
 $\Phi 12$

JL-3063



Size: $\Phi 6$
 $\Phi 8$
 $\Phi 10$
 $\Phi 12$

JL-3064



Size: $\Phi 6$
 $\Phi 8$
 $\Phi 10$
 $\Phi 12$

JL-3065



Size: $\Phi 6$
 $\Phi 8$
 $\Phi 10$
 $\Phi 12$

接头 Fitting

JL-3066



Size: M22
M16

JL-3067



Size: M22-12

JL-3068



Size: M22-2 x 12

JL-3069



Size: 12 x 12 x 12

JL-3070



Size: 8-10-135°

JL-3071



Size: M22 x 1.5-M12

JL-3072



Size: M22 x 1.5-M12

JL-3073



Size:

铜接头 Brass Fitting

JL-3074



Size: M6
M8
M10
M12

JL-3075



Size: M6
M8
M10
M12
6-8-8
8-6-8
10-8-10
8-10-10

JL-3076



Size: 12*1.5-22-12

JL-3077



Size: 12*1.5-16-8
12*1.5-22-8

JL-3078



Size: 2×6-M10×1-8

JL-3079



Size: 12*1.5-2×8

JL-3080



Size: 2×M16×1.5-6

JL-3081



Size: M18×1.5-14

铜接头 Brass Fitting

JL-3082



Size: M6
M8
M10
M12

JL-3083



Size: M6
M8
M10
M12

JL-3084



Size: M6
M8
M10
M12

JL-3085



Size: M16*1.5
M22*1.5

JL-3086



Size: M16*1.5
M22*1.5

JL-3087



Size: M16*1.5
M22*1.5

JL-3088



Size:

JL-3089



Size: M8 × 1
M10 × 1.5
M12 × 1.5
M14 × 1.5
M16 × 1.5
M18 × 1.5

自封阀 Automatic Coupling

JL-4001



Size: 16*1.5
22*1.5
1/2
3/4
1

JL-4002



Size: 16*1.5
22*1.5
1/2
3/4
1

JL-4003



Size: 16*1.5
22*1.5
1/2
3/4
1

JL-4004



Size: 16*1.5
22*1.5
1/2
3/4
1

JL-4005



Size: 16*1.5
22*1.5
1/2
3/4
1

JL-4006



Size: 16*1.5
22*1.5
1/2
3/4
1

JL-4007



Size: 16*1.5
22*1.5
1/2
3/4
1

JL-4008



Size: 16*1.5
22*1.5
1/2
3/4
1

自封阀 Automatic Coupling

JL-4009



Size: 6×6
8×8
10×10
12×12

JL-4010



Size: 6×6
8×8
10×10
12×12

JL-4011



Size: 6×6
8×8
10×10
12×12

JL-4012



Size: 6×6
8×8
10×10
12×12

JL-4013



Size: 1m
2m
3m
4m
5m
8m
10m
15m

JL-4014



Size: 1m
2m
3m
4m
5m
8m
10m
15m

JL-4015



Size: 1.5m
2m
3m
4m
5m
6m

JL-4016

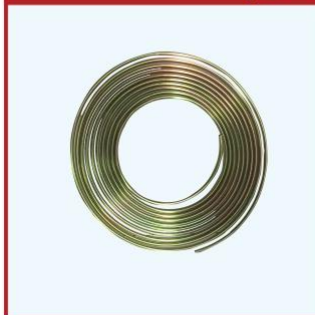

Size: 4mm
6mm
8mm
10mm
12mm
1/4
3/8
1/2
5/8

液压接头 Hydraulic Fitting

JL-5001

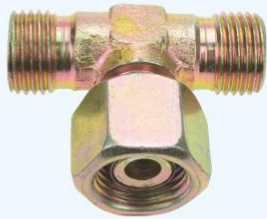

Size: M12 × 1.5
M14 × 1.5
M16 × 1.5
M18 × 1.5
M22 × 1.5

JL-5002



Size: M12 × 1.5
M14 × 1.5
M16 × 1.5
M18 × 1.5
M22 × 1.5

JL-5003



Size: M12 × 1.5
M14 × 1.5
M16 × 1.5
M18 × 1.5
M22 × 1.5

JL-5004



Size: M12 × 1.5
M14 × 1.5
M16 × 1.5
M18 × 1.5
M22 × 1.5

JL-5005



Size: 16 × 1.5-8
16 × 1.5-10
22 × 1.5-10
22 × 1.5-12

JL-5006



Size: Z3/4 × M27 × 1.5

JL-5007



Size: M12 × 1.5
M14 × 1.5
M16 × 1.5
M18 × 1.5
M22 × 1.5

JL-5008



Size: M12 × 1.5
M14 × 1.5
M16 × 1.5
M18 × 1.5
M22 × 1.5

铁接头 Iron Fitting

JL-5009



Size: M8 × 1
M10 × 1.5
M12 × 1.5
M14 × 1.5
M16 × 1.5
M18 × 1.5

JL-5010



Size: M8 × 1
M10 × 1.5
M12 × 1.5
M14 × 1.5
M16 × 1.5
M18 × 1.5

JL-5011



Size: 12 × 6 14 × 6
12 × 8 14 × 8
12 × 10 14 × 10
8 × 6 14 × 12
10 × 8 16 × 6
16 × 8
16 × 10
16 × 12

JL-5012



Size: 12 × 6 14 × 6
12 × 8 14 × 8
12 × 10 14 × 10
8 × 6 14 × 12
10 × 8 16 × 6
16 × 8
16 × 10
16 × 12

JL-5013



Size: M10
M12
M14
M16

JL-5014



Size: 12 × 10
14 × 10
14 × 12
16 × 10
16 × 12

JL-5015



Size: M22 × 1.5-M6
M22 × 1.5-M8
M22 × 1.5-M10
M22 × 1.5-M12
M22 × 1.5-M14

JL-5016



Size: M22 × 1.5-M6
M22 × 1.5-M8
M22 × 1.5-M10
M22 × 1.5-M12
M22 × 1.5-M14

铁接头 Iron Fitting

JL-5017



Size: M22 × 1.5-M6
M22 × 1.5-M8
M22 × 1.5-M10
M22 × 1.5-M12

JL-5018



Size: M22 × 1.5-M6
M22 × 1.5-M8
M22 × 1.5-M10
M22 × 1.5-M12
M22 × 1.5-M14

JL-5019



Size: M22 × 1.5-M6
M22 × 1.5-M8
M22 × 1.5-M10
M22 × 1.5-M12
M22 × 1.5-M14

JL-5020



Size: M22 × 1.5-M6
M22 × 1.5-M8
M22 × 1.5-M10
M22 × 1.5-M12
M22 × 1.5-M14

JL-5021



Size: M22 × 1.5-M6
M22 × 1.5-M8
M22 × 1.5-M10
M22 × 1.5-M12
M22 × 1.5-M14

JL-5022



Size: M8
M10
M12
M14
M16

JL-5023



Size: M8
M10
M12
M14
M16

JL-5024



Size: M8
M10
M12
M14
M16

管接头 Pipe Fitting

JL-5025



Size: M8 × 1
M10 × 1.5
M12 × 1.5
M14 × 1.5
M16 × 1.5
M18 × 1.5

JL-5026



Size: M12 × 1.5
M14 × 1.5
M16 × 1.5
M18 × 1.5
M22 × 1.5

JL-5027

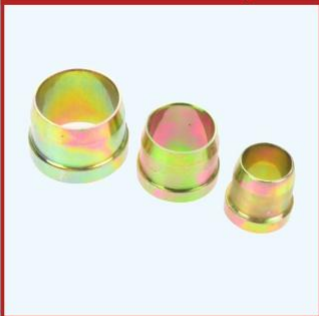

Size: Φ4, Φ5,
Φ6, Φ8,
Φ10, Φ12,
Φ14, Φ16

JL-5028



Size: Φ4, Φ5,
Φ6, Φ8,
Φ10, Φ12,
Φ14, Φ16

JL-5029



Size: Φ4, Φ5,
Φ6, Φ8,
Φ10, Φ12,
Φ14, Φ16

JL-5030

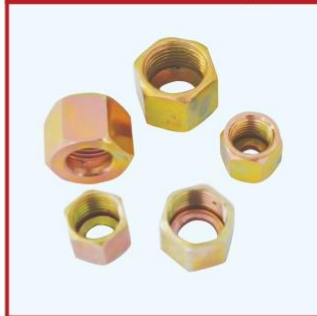

Size: M12 × 1.5
M14 × 1.5
M16 × 1.5
M18 × 1.5
M22 × 1.5
M24 × 1.5
M26 × 1.5
M30 × 1.5

JL-5031



Size: M12 × 1.5
M14 × 1.5
M16 × 1.5
M18 × 1.5
M22 × 1.5
M24 × 1.5
M26 × 1.5
M30 × 1.5

JL-5032



Size: Φ15
Φ16

管接头 Pipe Fitting

JL-5033

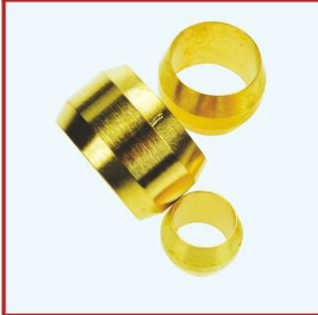

Size: $\Phi 4$ $\Phi 5$
 $\Phi 6$ $\Phi 8$
 $\Phi 10$ $\Phi 12$
 $\Phi 14$ $\Phi 16$

JL-5034



Size: $\Phi 4$ $\Phi 6$
 $\Phi 8$ $\Phi 10$
 $\Phi 12$ $\Phi 14$
 $\Phi 16$

JL-5035



Size: M12 \times 1.5
M14 \times 1.5
M16 \times 1.5
M18 \times 1.5
M22 \times 1.5
M24 \times 1.5
M26 \times 1.5
M30 \times 1.5

JL-5036



Size: $\Phi 4$ $\Phi 5$
 $\Phi 6$ $\Phi 8$
 $\Phi 10$ $\Phi 12$
 $\Phi 14$ $\Phi 16$

JL-5037



Size: $\Phi 4$ $\Phi 6$
 $\Phi 8$ $\Phi 10$
 $\Phi 12$ $\Phi 14$
 $\Phi 16$

JL-5038

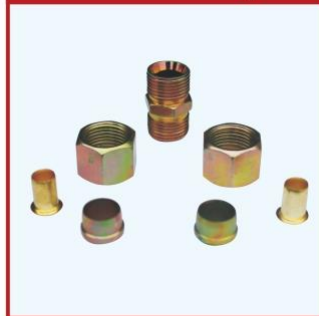

Size: $\Phi 4$ $\Phi 6$
 $\Phi 8$ $\Phi 10$
 $\Phi 12$ $\Phi 14$
 $\Phi 16$

JL-5039



Size: $\Phi 4$ $\Phi 6$
 $\Phi 8$ $\Phi 10$
 $\Phi 12$ $\Phi 14$
 $\Phi 16$

JL-5040



Size: $\Phi 4$ $\Phi 6$
 $\Phi 8$ $\Phi 10$
 $\Phi 12$ $\Phi 14$
 $\Phi 16$

管接头 Pipe Fitting

JL-5041



Size: 16-12
16-14
16-16
18-14
18-16
18-18
22-16
22-18
22-22

JL-5042



Size: M16-M18

JL-5043



Size: 18-16
18-18
22-16
22-18

JL-5044

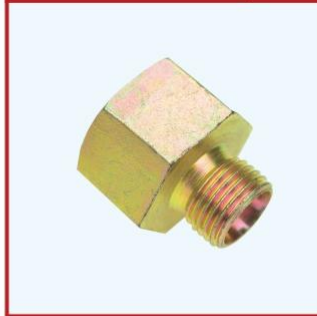

Size: 22-16
22-18

JL-5045



Size: M22 × 1.5
-M16 × 1.5
M22 × 1.5
-M18 × 1.5

JL-5046



Size: M12 × 1.5
M14 × 1.5
M16 × 1.5
M18 × 1.5
M20 × 1.5
M22 × 1.5
M24 × 1.5
M26 × 1.5

JL-5047



Size: 18-18
22-16
22-18

JL-5048



Size: M12 × 1.5
M14 × 1.5
M16 × 1.5
M18 × 1.5
M22 × 1.5

管接头 Pipe Fitting

JL-5049



Size: M12 × 1.5
M14 × 1.5
M16 × 1.5
M18 × 1.5
M22 × 1.5

JL-5050



Size: M12 × 1.5
M14 × 1.5
M16 × 1.5
M18 × 1.5
M22 × 1.5

JL-5051



Size: M18 × 1.5-3
M22 × 1.5-3

JL-5052



Size: M16 × 1.5
-M18 × 1.5 × 2

JL-5053



Size: M12 × 1.5
M14 × 1.5
M16 × 1.5
M18 × 1.5
M22 × 1.5

JL-5054



Size: M22
M24
M26
3/8
1/2
3/4

JL-5055



Size: 1/2
3/8
3/4

JL-5056



Size: Φ4 Φ5
Φ6 Φ8
Φ10 Φ12
Φ14 Φ16

配件 Automotive Spare Part

JL-5057



Size: $\Phi 6.3-9$
 $\Phi 6.3-8$
 $\Phi 7.89-6$
 $\Phi 7.89-8$
 $\Phi 9.49-6$
 $\Phi 9.49-8$

JL-5058



Size: $\Phi 6.3$
 $\Phi 7.89$
 $\Phi 9.49$

JL-5059



Size: M16
M22

JL-5060



Size: $\Phi 12$, $\Phi 14$,
 $\Phi 16$, $\Phi 18$,
 $\Phi 20$, $\Phi 22$,
 $\Phi 24$

JL-5061



Size:

JL-5062



Size:

JL-5063



Size:

JL-5064



Size:

O型圈修理盒 -Ring Set

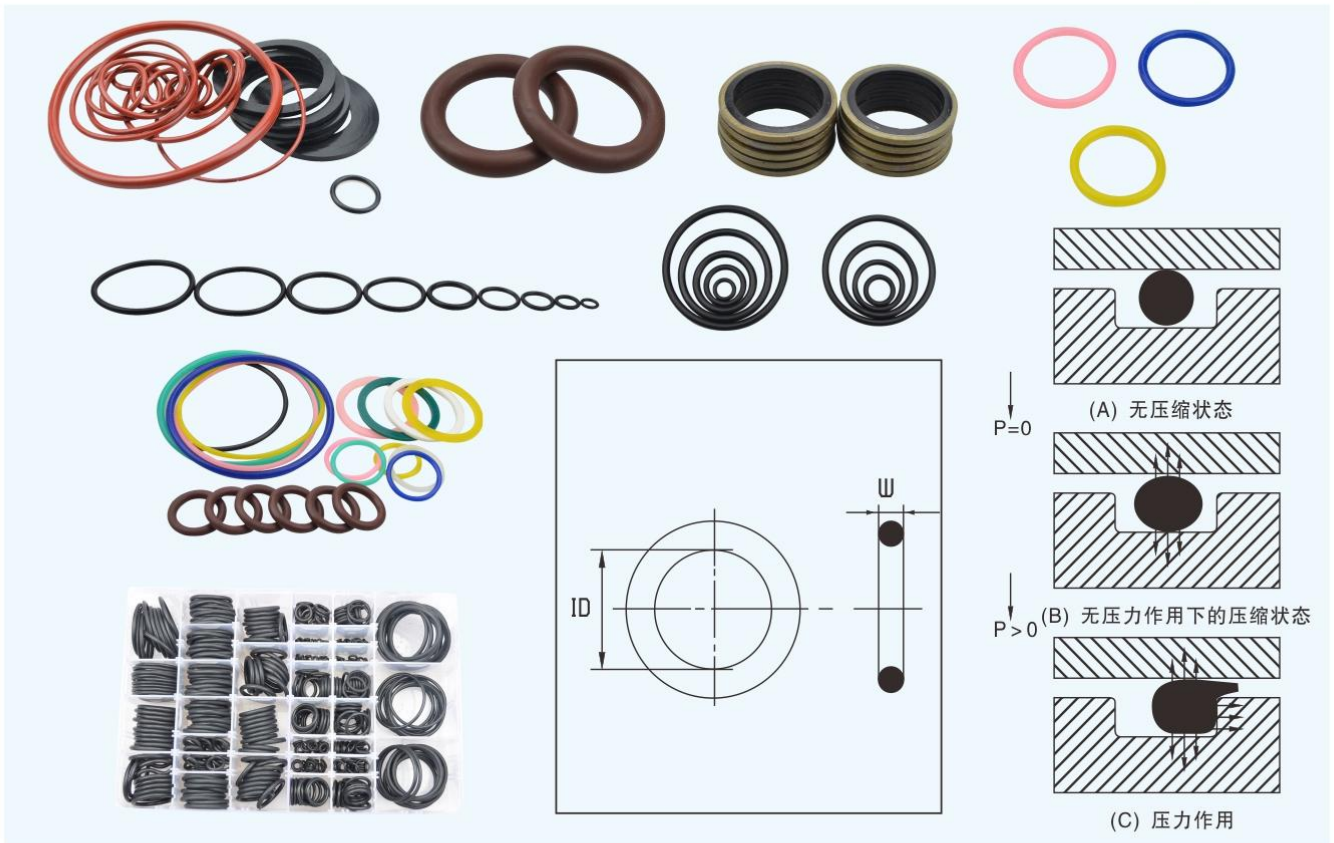

O型圈修理盒 O-Ring Set



O型圈修理盒 O-Ring Set

HITACHI

JL-6007



KOBELCO

JL-6008



HYUNDAI

JL-6009



KOMATSU

JL-6010



SUMITOMO

JL-6011



KATO

JL-6012



C紫铜垫片修理盒 Copper Washer



紫铜垫片修理盒 Copper washer

110PC

JL-6013



150PC

JL-6014



160PC

JL-6015



220PC

JL-6016



300PC

JL-6017



540PC

JL-6018



紫铜垫片修理盒 Copper washer

568PC

JL-6019



570PC

JL-6020



五金件修理盒 Hardware Kit

200pcs spring repair set

JL-6021



110pcs Grease nipple

JL-6022



800pcs spring cushion repair set

JL-6023



150pcs lockpin repair set

JL-6024



五金件修理盒 Hardware Kit

144pcs cotter repair set

JL-6025



150pcs self-locking nut

JL-6026



300pcs Snap ring assortment

JL-6027



50pcs Lynch pin assortment

JL-6028



106pcs Allan cap screw set

JL-6029



20pcs Pto pin assortment

JL-6030

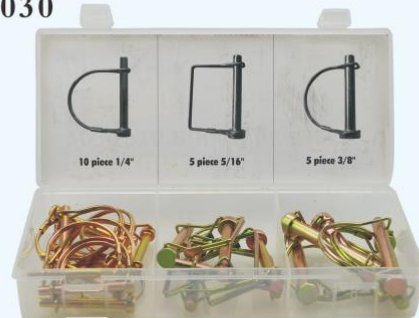

配件 Automotive Spare Part

JL-7001



Size:

JL-7002



Size: M12 × 1.5
M16 × 1.5

JL-7003



Size: 22*1.5
1/2

JL-7004



Size:

JL-7005



Size: 22*1.5
1/2

JL-7006



Size:

JL-7007



Size: 6mm
8mm

JL-7008

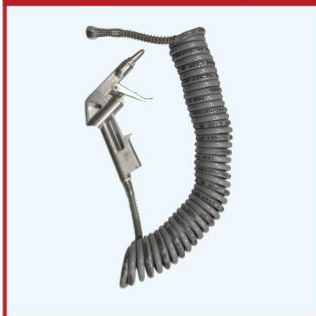

Size:

配件 Automotive Spare Part

JL-7009



JL-7010



Size: 270 × 25
× 12 × 4.4
180 × 23
× 18 × 4

JL-7011



Size:

JL-7012



Size: 180 × 19
× 47.5 × 2.4

JL-7013



Size:

JL-7014



Size: 280 × 35
× 13 × 5.5
210 × 31
× 10 × 4.8

JL-7015



Size: 220 × 26
× 26 × 3
135 × 19
× 20 × 3

JL-7016



Size: 19.5 × 9 × 3.5

配件 Automotive Spare Part

JL-7017



Size: M6 × 1
M8 × 1
M10 × 1

JL-7018



Size: M6 × 1
M8 × 1
M10 × 1

JL-7019



Size: M6 × 1
M8 × 1
M10 × 1

JL-7020



Size:

JL-7021



Size: 6*6
8*6
8*8
10*10
12*12

JL-7022



Size: 6*6
8*6
8*8
10*10
12*12

JL-7023



Size: 6*6
8*6
8*8
10*10
12*12

JL-7024



Size:

定做产品 Customer Make Part

JL-7025



Size: 17-19 20-22
23-25 26-28
29-31 32-35
36-39 40-43
44-47 48-57
52-55 56-59
60-63 64-67
68-73 74-79
80-85 86-91
92-97 98-103

JL-7026



Size: M10-16
M13-19
M16-25
M22-32
M25-38
M44-64
M70-89
M100-120
M130-150
M180-240

JL-7027



Size: M14
M12

JL-7028



Size: M5 M6 M8
M10 M12 M14
M16 M18 M20
M24 M26 M28
M30

JL-7029



Size: M22-10
M22-12
M22-14
M22-16
M16-10
M16-12
M16-14

JL-7030



Size: M22-10
M22-12
M22-14
M22-16
M16-10
M16-12
M16-14

JL-7031



Size: M16-8
M16-10
M16-12
M22-8
M22-10
M22-12

JL-7032



Size: M16-16
M18-16
M18-18

定做产品 Customer Make Part

JL-7033



Size: M16 × 1.5-8

JL-7034



Size: M16 × 1.5-8
M18 × 1.5-8

JL-7035



Size:

JL-7036



Size:

JL-7037



Size:

JL-7038



Size: ϕ 0.5
 ϕ 1.0
 ϕ 1.5

JL-7039



Size:

JL-7040



Size: 30cm
40cm
50cm
60cm

JL-7041



Size:

JL-7042



Size:

H 标准软管接头 Hose fitting



标准软管接头 HOSE FITTING

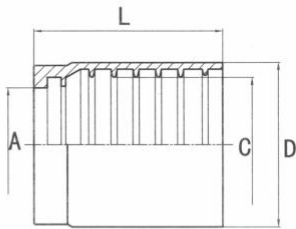

产品谱系00110		JL-8001		常用进口胶管一层套筒1SN			
序号	产品代号PART NO.	胶管HOSE BORE		尺寸DIMENSIONS			
		公称内径DN	标号DASH	A	D	C	L
1	00110-04A	6	04	11.2	21.0	14.0	27.5
2	00110-05A	8	05	12.7	21.5	15.6	28.0
3	00110-06A	10	06	14.4	24.3	18.0	30.0
4	00110-08A	13	08	18.6	28.0	21.5	34.0
5	00110-10A	16	10	21.3	31.3	24.5	37.0
6	00110-12A	19	12	24.6	35.5	28.7	42.0
7	00110-16A	25	16	30.6	43.5	36.3	51.0
8	00110-20	32	20	37.5	52.0	45.0	59.0
9	00110-24	38	24	44.0	58.0	51.5	74.0
10	00110-32	51	32	56.8	72.0	65.0	78.0

注：与编织接头配用。NOTE:Match with braided fitting

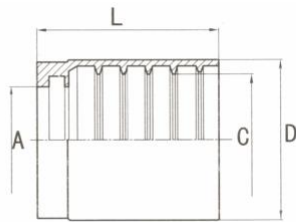

产品谱系03310		JL-8002		常用进口胶管二层套筒2SN			
序号	产品代号PART NO.	胶管HOSE BORE		尺寸DIMENSIONS			
		公称内径DN	标号DASH	A	D	C	L
1	03310-04	6	04	11.0	23.0	15.7	30.5
2	03310-05	8	05	12.7	24.0	17.3	30.0
3	03310-06	10	06	14.4	26.0	19.6	32.0
4	03310-08	13	08	18.6	29.0	23.1	34.0
5	03310-10	16	10	21.3	33.0	26.2	37.0
6	03310-12	19	12	24.6	37.0	30.3	42.0
7	03310-16	25	16	30.6	46.7	38.8	51.0
8	03310-20	32	20	39.5	59.0	49.6	59.0
9	03310-24	38	24	44.9	67.0	55.7	67.0
10	03310-32	51	32	57.0	80.0	68.5	72.0

注：与编织接头配用。NOTE:Match with braided fitting

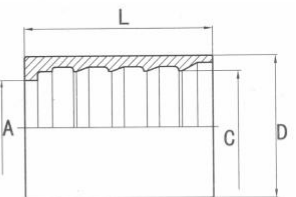

产品谱系00400/00401		JL-8003		常用进口胶管四层套筒			
序号	产品代号PART NO.	胶管HOSE BORE		尺寸DIMENSIONS			
		公称内径DN	标号DASH	A	D	C	L
1	00400-04	6	04	11.5	22.0	15.5	37.5
2	00400-06	10	06	14.7	25.5	18.3	39.0
3	00400-08	13	08	17.5	29.0	21.3	41.0
4	00400-10	16	10	21.0	32.5	24.5	43.0
5	00400-12	19	12	24.5	37.0	29.0	51.0
6	00400-16	25	16	31.0	46.5	36.5	61.5
7	00401-20	32	20	38.3	53.0	42.8	67.5
8	00401-24	38	24	44.3	61.0	49.8	75.0
9	00401-32	51	32	57.0	77.0	64.5	79.0

注：与缠绕接头配用。NOTE:Match with spiral fitting

标准软管接头 HOSE FITTING

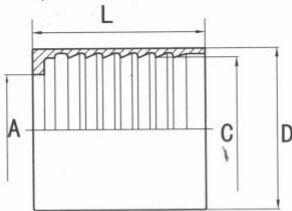

产品谱系00210		JL-8004		常用进口胶管二层套筒2SN			
序号	产品代号PART NO.	胶管HOSE BORE		尺寸DIMENSIONS			
		公称内径DN	标号DASH	A	D	C	L
1	00210-20	32	20	37.5	55.0	48.8	59.0
2	00210-24	38	24	44.0	62.5	55.5	74.0
3	00210-32	51	32	56.8	75.5	68.3	78.0

注：与编织接头配用。NOTE: Match with braided fitting
注：可代替03310系列。NOTE: Replace 03310 series product

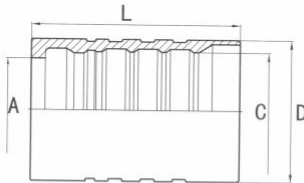

产品谱系00621		JL-8005		常用进口胶管六层套筒			
序号	产品代号PART NO.	胶管HOSE BORE		尺寸DIMENSIONS			
		公称内径DN	标号DASH	A	D	C	L
1	00621-20	32	20	43.4	60.0	49.2	88.5
2	00621-24	38	24	49.5	69.4	55.5	102.0
3	00621-32	51	32	64.5	86.5	70.7	108.0

注：GH466 软管剥内外胶管套筒。NOTE: Interlock ferrule for GH466

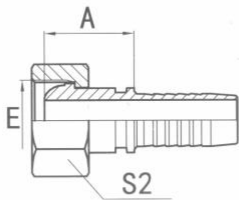

20111T

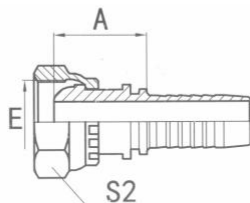

20111

产品谱系20111		JL-8006		公制内螺纹球面			
序号	产品代号PART NO.	螺纹制式THREAD E	胶管HOSE BORE		尺寸DIMENSIONS		
			公称内径DN	标号DASH	A	S2	
1	20111-14-04T	M14 × 1.5	6	04	20.5	S17	
2	20111-16-05T	M16 × 1.5	8	05	20.0	S19	
3	20111-16-06	M16 × 1.5	10	06	20.0	S22	
4	20111-18-05T	M18 × 1.5	8	05	21.5	S22	
5	20111-18-06T	M18 × 1.5	10	06	22.5	S22	
6	20111-18-08	M18 × 1.5	13	08	22.0	S24	
7	20111-22-06T	M22 × 1.5	10	06	21.0	S27	
8	20111-22-08T	M22 × 1.5	13	08	24.5	S27	
9	20111-27-08T	M27 × 1.5	13	08	23.0	S32	
10	20111-27-10T	M27 × 1.5	16	10	23.5	S32	
11	20111-30-10T	M30 × 1.5	16	10	28.5	S36	
12	20111-30-12T	M30 × 1.5	19	12	28.5	S36	
13	20111-36-12T	M36 × 2.0	19	12	26.0	S41	
14	20111-36-16T	M36 × 2.0	25	16	28.0	S41	
15	20111-39-16T	M39 × 2.0	25	16	29.5	S46	
16	20111-42-16T	M42 × 2.0	25	16	30.0	S50	
17	20111-45-20T	M45 × 2.0	32	20	31.5	S55	
18	20111-52-20T	M52 × 2.0	32	20	33.0	S60	
19	20111-52-24T	M52 × 2.0	38	24	33.0	S60	
20	20111-64-32T	M64 × 2.0	51	32	35.0	S75	

注：1表中代号用于编制软管
2如需用于缠绕软管代号改为20112-XX-XX
1后缀为空表示为收口螺帽
2后缀为T表示为套螺帽
3后缀为W表示为穿钢丝螺帽

标准软管接头 HOSE FITTING

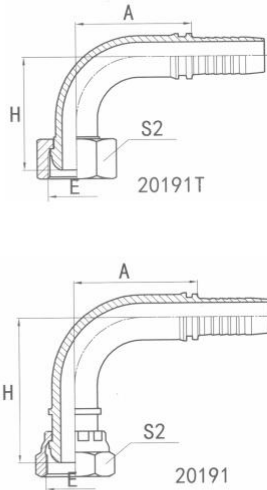

产品谱系20191			JL-8007		90° 公制内螺纹球面		
序号	产品代号 PART NO.	螺纹制式 THREAD E	胶管HOSE BORE		尺寸DIMENSIONS		
			公称内径DN	标号DASH	A	H	S2
1	20191-14-04T	M14×1.5	6	04	28.1	33.8	S17
2	20191-16-05T	M16×1.5	8	05	31.8	38.5	S19
3	20191-16-06	M16×1.5	10	06	35.5	43.0	S22
4	20191-18-05T	M18×1.5	8	05	31.0	40.0	S22
5	20191-18-06T	M18×1.5	10	06	33.3	41.0	S22
6	20191-18-08	M18×1.5	13	08	36.5	38.5	S24
7	20191-22-06T	M22×1.5	10	06	35.0	43.5	S27
8	20191-22-08T	M22×1.5	13	08	41.8	49.0	S27
9	20191-27-08T	M27×1.5	13	08	41.8	52.0	S32
10	20191-27-10T	M27×1.5	16	10	54.0	54.0	S32
11	20191-30-10T	M30×1.5	16	10	52.5	54.0	S36
12	20191-30-12T	M30×1.5	19	12	61.0	59.0	S36
13	20191-36-12T	M36×2.0	19	12	61.0	62.0	S41
14	20191-36-16T	M36×2.0	25	16	75.5	70.0	S41
15	20191-39-16T	M39×2.0	25	16	75.5	72.0	S46
16	20191-42-16T	M42×2.0	25	16	75.5	72.0	S50
17	20191-45-20T	M45×2.0	32	20	91.5	85.0	S55
18	20191-52-20T	M52×2.0	32	20	91.5	86.0	S60
19	20191-52-24T	M52×2.0	38	24	106.4	109.4	S60
20	20191-64-32T	M64×2.0	51	32	131.0	113.3	S75

注：1表中代号用于编制软管
2如需用于缠绕软管代号改为20192-XX-XX

1后缀为空表示为收口螺帽
2后缀为T表示为套螺帽
3后缀为W表示为穿钢丝螺帽

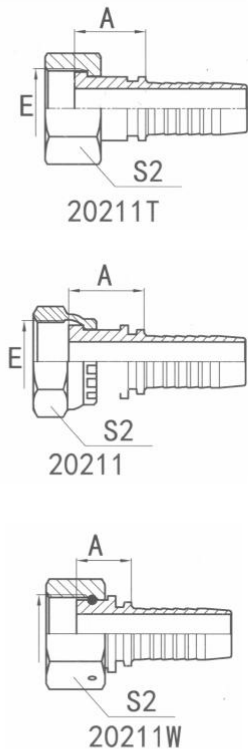

产品谱系20211			JL-8008		公制内螺纹球面		
序号	产品代号 PART NO.	螺纹制式 THREAD E	胶管HOSE BORE		尺寸DIMENSIONS		
			公称内径DN	标号DASH	A		S2
1	20211-12-04	M12×1.5	6	04	15.0		S17
2	20211-14-04T	M14×1.5	6	04	16.5		S17
3	20211-16-04T	M16×1.5	6	04	16.0		S19
4	20211-16-05T	M16×1.5	8	05	16.5		S19
5	20211-16-06	M16×1.5	10	06	16.5		S22
6	20211-18-05T	M18×1.5	8	05	15.0		S22
7	20211-18-06T	M18×1.5	10	06	17.0		S22
8	20211-22-06T	M22×1.5	10	06	16.0		S27
9	20211-22-08T	M22×1.5	13	08	19.5		S27
10	20211-27-08T	M27×1.5	13	08	18.5		S32
11	20211-27-10T	M27×1.5	16	10	19.5		S32
12	20211-30-10T	M30×1.5	16	10	18.0		S36
13	20211-30-12T	M30×1.5	19	12	23.5		S36
14	20211-36-12T	M36×2.0	19	12	20.0		S41
15	20211-36-16T	M36×2.0	25	16	24.0		S41
16	20211-39-16T	M39×2.0	25	16	23.5		S46
17	20211-42-16T	M42×2.0	25	16	23.5		S50
18	20211-42-20W	M42×2.0	32	20	25.0		S50
19	20211-45-16T	M45×2.0	25	16	24.0		S55
20	20211-45-20T	M45×2.0	32	20	25.0		S55
21	20211-52-20T	M52×2.0	32	20	25.0		S60
22	20211-52-24T	M52×2.0	38	24	25.0		S60
23	20211-64-32T	M64×2.0	51	32	26.0		S75

注：1表中代号用于编制软管
2如需用于缠绕软管代号改为20212-XX-XX

1后缀为空表示为收口螺帽
2后缀为T表示为套螺帽
3后缀为W表示为穿钢丝螺帽

标准软管接头 HOSE FITTING

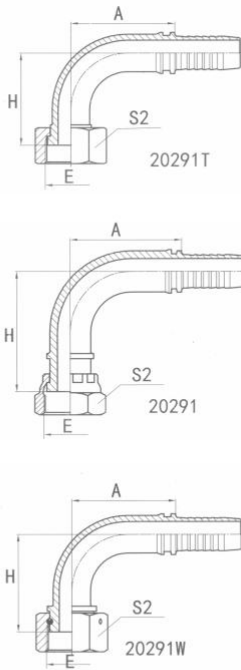

产品谱系20291			JL-8009		90° 公制内螺纹球面		
序号	产品代号 PART NO.	螺纹制式 THREAD E	胶管HOSE BORE		尺寸DIMENSIONS		
			公称内径DN	标号DASH	A	H	S2
1	20291-12-04	M12 × 1.5	6	04	30.0	33.5	S17
2	20291-14-04T	M14 × 1.5	6	04	28.4	30.0	S17
3	20291-16-04T	M16 × 1.5	6	04	30.0	34.5	S19
4	20291-16-05T	M16 × 1.5	8	05	34.0	37.5	S19
5	20291-16-06	M16 × 1.5	10	06	35.5	40.0	S22
6	20291-18-05T	M18 × 1.5	8	05	34.0	37.5	S22
7	20291-18-06T	M18 × 1.5	10	06	35.3	39.0	S22
8	20291-22-06T	M22 × 1.5	10	06	35.0	39.0	S27
9	20291-22-08T	M22 × 1.5	13	08	41.8	44.0	S27
10	20291-27-08T	M27 × 1.5	13	08	41.8	45.0	S32
11	20291-27-10T	M27 × 1.5	16	10	54.0	49.5	S32
12	20291-30-10T	M30 × 1.5	16	10	54.0	50.0	S36
13	20291-30-12T	M30 × 1.5	19	12	61.0	54.0	S36
14	20291-36-12T	M36 × 2.0	19	12	61.0	55.0	S41
15	20291-36-16T	M36 × 2.0	25	16	74.2	64.0	S41
16	20291-39-16T	M39 × 2.0	25	16	76.5	66.0	S46
17	20291-42-16T	M42 × 2.0	25	16	76.5	66.0	S50
18	20291-42-20W	M42 × 2.0	32	20	91.5	80.0	S50
19	20291-45-16T	M45 × 2.0	25	16	76.5	68.0	S55
20	20291-45-20T	M45 × 2.0	32	20	91.5	78.5	S55
21	20291-52-20T	M52 × 2.0	32	20	91.5	79.0	S60
22	20291-52-24T	M52 × 2.0	38	24	106.4	92.0	S60
23	20291-64-32T	M64 × 2.0	51	32	131.0	113.3	S75

注：1表中代号用于编制软管
2如需用于缠绕软管代号改为20292-XX-XX
1后缀为空表示为收口螺帽
2后缀为T表示为套螺帽
3后缀为W表示为穿钢丝螺帽

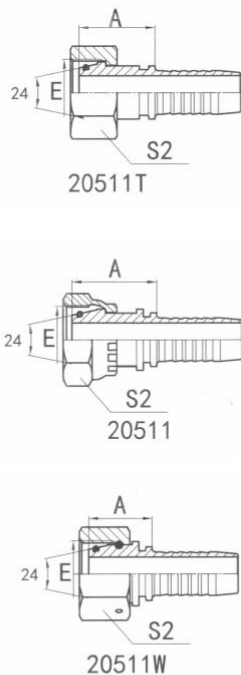

产品谱系20511			JL-8010		公制内螺纹24° 锥带O形圈(重)		
序号	产品代号 PART NO.	螺纹制式 THREAD E	胶管HOSE BORE		O形圈	尺寸DIMENSIONS	
			公称内径DN	标号DASH		A	S2
1	20511-14-04T	M14 × 1.5	6	04	O04.5 × 1.5	25.0	S17
2	20511-16-04T	M16 × 1.5	6	04	O06.5 × 1.5	24.5	S19
3	20511-16-05T	M16 × 1.5	8	05	O06.5 × 1.5	25.0	S19
4	20511-16-06	M16 × 1.5	10	06	O06.5 × 1.5	27.5	S22
5	20511-18-04T	M18 × 1.5	6	04	O08.0 × 1.5	25.5	S22
6	20511-18-05T	M18 × 1.5	8	05	O08.0 × 1.5	24.5	S22
7	20511-18-06T	M18 × 1.5	10	06	O08.0 × 1.5	26.5	S22
8	20511-20-05T	M20 × 1.5	8	05	O10.0 × 1.5	26.5	S24
9	20511-20-06T	M20 × 1.5	10	06	O10.0 × 1.5	26.5	S24
10	20511-20-08	M20 × 1.5	13	08	O10.0 × 1.5	31.5	S27
11	20511-22-06T	M22 × 1.5	10	06	O11.0 × 2.0	26.5	S27
12	20511-22-08T	M22 × 1.5	13	08	O11.0 × 2.0	29.0	S27
13	20511-24-06T	M24 × 1.5	10	06	O13.0 × 2.0	27.0	S30
14	20511-24-08T	M24 × 1.5	13	08	O13.0 × 2.0	27.5	S30
15	20511-24-10W	M24 × 1.5	16	10	O13.0 × 2.0	26.5	S30
16	20511-30-08T	M30 × 2.0	13	08	O16.3 × 2.4	32.5	S36
17	20511-30-10T	M30 × 2.0	16	10	O16.3 × 2.4	33.0	S36
18	20511-30-12T	M30 × 2.0	19	12	O16.3 × 2.4	34.5	S36
19	20511-36-12TS41	M36 × 2.0	19	12	O20.3 × 2.4	35.0	S41
20	20511-36-12T	M36 × 2.0	19	12	O20.3 × 2.4	35.0	S46
21	20511-36-16T	M36 × 2.0	25	16	O20.3 × 2.4	37.0	S41
22	20511-36-16TS46	M36 × 2.0	25	16	O20.3 × 2.4	37.0	S46
23	20511-36-20W	M36 × 2.0	32	20	O20.3 × 2.4	33.5	S46
24	20511-42-16T	M42 × 2.0	25	16	O25.3 × 2.4	38.5	S50
25	20511-42-20W	M42 × 2.0	32	20	O25.3 × 2.4	31.5	S50
26	20511-42-24W	M42 × 2.0	38	24	O25.3 × 2.4	37.0	S50
27	20511-52-20T	M52 × 2.0	32	20	O33.3 × 2.4	41.5	S60
28	20511-52-24T	M52 × 2.0	38	24	O33.3 × 2.4	41.5	S60

注：1表中代号用于编制软管
2如需用于缠绕软管代号改为20512-XX-XX
1后缀为空表示为收口螺帽
2后缀为T表示为套螺帽
3后缀为W表示为穿钢丝螺帽

标准软管接头 HOSE FITTING

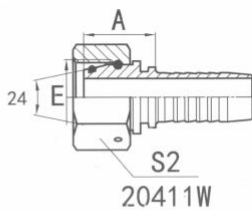
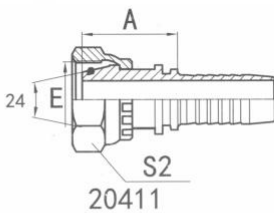
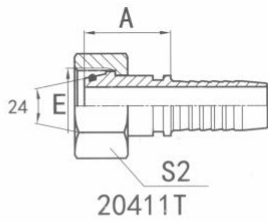

产品谱系20411

JL-8011

公制内螺纹24° 锥带O形圈(轻)

序号	产品代号 PART NO.	螺纹制式 THREAD E	胶管HOSE BORE		O形圈	尺寸DIMENSIONS	
			公称内径DN	标号DASH		A	S2
1	20411-12-04	M12×1.5	6	04	O04.5×1.5	26.0	S17
2	20411-14-04T	M14×1.5	6	04	O06.5×1.5	24.0	S17
3	20411-14-05	M14×1.5	8	05	O06.5×1.5	27.5	S19
4	20411-14-06	M14×1.5	10	06	O06.5×1.5	27.5	S19
5	20411-16-04T	M16×1.5	6	04	O08.0×1.5	23.0	S19
6	20411-16-05T	M16×1.5	8	05	O08.0×1.5	24.0	S19
7	20411-16-06	M16×1.5	10	06	O08.0×1.5	27.5	S22
8	20411-16-08	M16×1.5	13	08	O08.0×1.5	28.5	S22
9	20411-18-04T	M18×1.5	6	04	O10.0×1.5	24.5	S22
10	20411-18-05T	M18×1.5	8	05	O10.0×1.5	24.5	S22
11	20411-18-06T	M18×1.5	10	06	O10.0×1.5	25.0	S22
12	20411-18-08	M18×1.5	13	08	O10.0×1.5	29.5	S24
13	20411-20-06T	M20×1.5	10	06	O11.0×1.5	26.5	S24
14	20411-20-08	M20×1.5	13	08	O11.0×1.5	30.0	S27
15	20411-22-06T	M22×1.5	10	06	O12.0×1.5	26.5	S27
16	20411-22-08T	M22×1.5	13	08	O12.0×1.5	28.0	S27
17	20411-22-10W	M22×1.5	16	10	O12.0×1.5	25.5	S27
18	20411-26-08T	M26×1.5	13	08	O15.0×1.5	27.5	S32
19	20411-26-10T	M26×1.5	16	10	O15.0×1.5	28.8	S32
20	20411-26-12W	M26×1.5	19	12	O15.0×1.5	26.5	S36
21	20411-30-10T	M30×2.0	16	10	O20.0×2.0	31.0	S36
22	20411-30-12T	M30×2.0	19	12	O20.0×2.0	33.0	S36
23	20411-30-16W	M30×2.0	25	16	O20.0×2.0	31.0	S36
24	20411-36-12T	M36×2.0	19	12	O26.0×2.0	33.0	S41
25	20411-36-16T	M36×2.0	25	16	O26.0×2.0	35.0	S41
26	20411-36-20W	M36×2.0	32	20	O26.0×2.0	35.0	S41
27	20411-45-16T	M45×2.0	25	16	O32.0×2.0	37.0	S55
28	20411-45-20T	M45×2.0	32	20	O32.0×2.0	37.5	S55
29	20411-45-24W	M45×2.0	38	24	O32.0×2.0	34.0	S55
30	20411-52-20T	M52×2.0	32	20	O38.0×2.0	38.5	S60
31	20411-52-24T	M52×2.0	38	24	O38.0×2.0	38.5	S60

注：1表中代号用于编制软管
2如需用于缠绕软管代号改为20412-XX-XX

1后缀为空表示为收口螺帽
2后缀为T表示为套螺帽
3后缀为W表示为穿钢丝螺帽

标准软管接头 HOSE FITTING

产品谱系20441 JL-8012 45° 公制内螺纹24° 锥带O形圈(轻)

序号	产品代号 PART NO.	螺纹制式 THREAD E	胶管HOSE BORE		O形圈	尺寸DIMENSIONS		
			公称内径DN	标号DASH		A	H	S2
1	20441-12-04	M12 × 1.5	6	04	O04.5 × 1.5	37.5	17.0	S17
2	20441-14-04T	M14 × 1.5	6	04	O06.5 × 1.5	37.0	16.5	S17
3	20441-14-05	M14 × 1.5	8	05	O06.5 × 1.5	38.5	19.5	S19
4	20441-14-06	M14 × 1.5	10	06	O06.5 × 1.5	38.5	19.5	S19
5	20441-16-04T	M16 × 1.5	6	04	O08.0 × 1.5	37.0	18.5	S19
6	20441-16-05T	M16 × 1.5	8	05	O08.0 × 1.5	40.0	19.5	S19
7	20441-16-06	M16 × 1.5	10	06	O08.0 × 1.5	40.0	20.5	S22
8	20441-16-08	M16 × 1.5	13	08	O08.0 × 1.5	41.0	20.5	S22
9	20441-18-04T	M18 × 1.5	6	04	O10.0 × 1.5	41.0	20.5	S22
10	20441-18-05T	M18 × 1.5	8	05	O10.0 × 1.5	46.0	23.0	S22
11	20441-18-06T	M18 × 1.5	10	06	O10.0 × 1.5	42.0	20.0	S22
12	20441-18-08	M18 × 1.5	13	08	O10.0 × 1.5	45.0	20.0	S24
13	20441-20-06T	M20 × 1.5	10	06	O11.0 × 1.5	48.0	23.0	S24
14	20441-20-08	M20 × 1.5	13	08	O11.0 × 1.5	48.0	23.0	S27
15	20441-22-06T	M22 × 1.5	10	06	O12.0 × 1.5	48.5	24.0	S27
16	20441-22-08T	M22 × 1.5	13	08	O12.0 × 1.5	61.0	25.0	S27
17	20441-22-10W	M22 × 1.5	16	10	O12.0 × 1.5	62.0	26.0	S27
18	20441-26-08T	M26 × 1.5	13	08	O15.0 × 1.5	60.5	26.0	S32
19	20441-26-10T	M26 × 1.5	16	10	O15.0 × 1.5	65.0	26.0	S32
20	20441-26-12W	M26 × 1.5	19	12	O15.0 × 1.5	61.0	26.0	S36
21	20441-30-10T	M30 × 2.0	16	10	O20.0 × 2.0	66.5	27.5	S36
22	20441-30-12T	M30 × 2.0	19	12	O20.0 × 2.0	74.0	29.0	S36
23	20441-30-16W	M30 × 2.0	25	16	O20.0 × 2.0	84.0	32.0	S36
24	20441-36-12T	M36 × 2.0	19	12	O26.0 × 2.0	74.5	29.5	S41
25	20441-36-16T	M36 × 2.0	25	16	O26.0 × 2.0	86.0	33.0	S41
26	20441-36-20W	M36 × 2.0	32	20	O26.0 × 2.0	97.2	32.5	S41
27	20441-45-16T	M45 × 2.0	25	16	O32.0 × 2.0	88.0	35.0	S55
28	20441-45-20T	M45 × 2.0	32	20	O32.0 × 2.0	100.0	39.5	S55
29	20441-45-24W	M45 × 2.0	38	24	O32.0 × 2.0	108.0	41.0	S55
30	20441-52-20T	M52 × 2.0	32	20	O38.0 × 2.0	100.5	40.0	S60
31	20441-52-24T	M52 × 2.0	38	24	O38.0 × 2.0	119.0	43.0	S60

注：1表中代号用于编制软管
2如需用于缠绕软管代号改为20442-XX-XX

1后缀为空表示为收口螺帽
2后缀为T表示为套螺帽
3后缀为W表示为穿钢丝螺帽

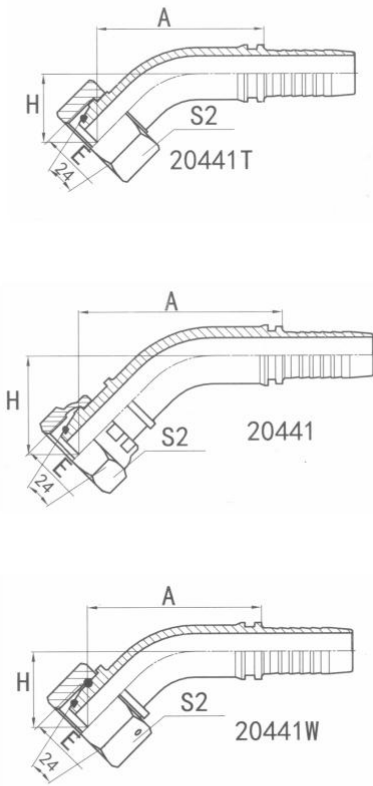

标准软管接头 HOSE FITTING

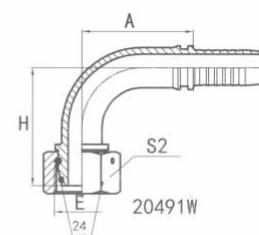
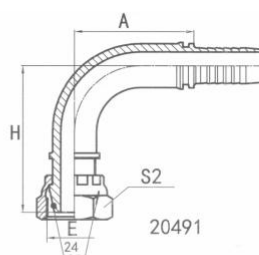
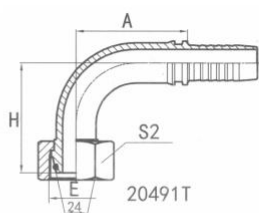

产品谱系20491 JL-8013 90° 公制内螺纹24° 锥带O形圈(轻)

序号	产品代号 PART NO.	螺纹制式 THREAD E	胶管HOSE BORE		O形圈	尺寸DIMENSIONS		
			公称内径DN	标号DASH		A	H	S2
1	20491-12-04	M12 × 1.5	6	04	O04.5 × 1.5	27.0	30.0	S17
2	20491-14-04T	M14 × 1.5	6	04	O06.5 × 1.5	28.5	30.5	S17
3	20491-14-05	M14 × 1.5	8	05	O06.5 × 1.5	27.0	34.5	S19
4	20491-14-06	M14 × 1.5	10	06	O06.5 × 1.5	27.0	35.0	S19
5	20491-16-04T	M16 × 1.5	6	04	O08.0 × 1.5	27.5	33.0	S19
6	20491-16-05T	M16 × 1.5	8	05	O08.0 × 1.5	32.0	36.0	S19
7	20491-16-06	M16 × 1.5	10	06	O08.0 × 1.5	30.0	37.0	S22
8	20491-16-08	M16 × 1.5	13	08	O08.0 × 1.5	31.0	37.5	S22
9	20491-18-04T	M18 × 1.5	6	04	O10.0 × 1.5	28.0	37.0	S22
10	20411-18-05T	M18 × 1.5	8	05	O10.0 × 1.5	31.0	40.0	S22
11	20491-18-06T	M18 × 1.5	10	06	O10.0 × 1.5	33.0	38.0	S22
12	20491-18-08	M18 × 1.5	13	08	O10.0 × 1.5	36.5	40.0	S24
13	20491-20-06T	M20 × 1.5	10	06	O11.0 × 1.5	35.0	43.0	S24
14	20491-20-08	M20 × 1.5	13	08	O11.0 × 1.5	35.5	43.0	S27
15	20491-22-06T	M22 × 1.5	10	06	O12.0 × 1.5	32.5	44.5	S27
16	20491-22-08T	M22 × 1.5	13	08	O12.0 × 1.5	42.0	49.0	S27
17	20491-22-10W	M22 × 1.5	16	10	O12.0 × 1.5	42.0	51.0	S27
18	20491-26-08T	M26 × 1.5	13	08	O15.0 × 1.5	41.0	50.5	S32
19	20491-26-10T	M26 × 1.5	16	10	O15.0 × 1.5	53.0	53.5	S32
20	20491-26-12W	M26 × 1.5	19	12	O15.0 × 1.5	58.0	58.0	S36
21	20491-30-10T	M30 × 2.0	16	10	O20.0 × 2.0	53.0	59.0	S36
22	20491-30-12T	M30 × 2.0	19	12	O20.0 × 2.0	61.0	60.5	S36
23	20491-30-16W	M30 × 2.0	25	16	O20.0 × 2.0	67.0	64.5	S36
24	20491-36-12T	M36 × 2.0	19	12	O26.0 × 2.0	61.0	61.0	S41
25	20491-36-16T	M36 × 2.0	25	16	O26.0 × 2.0	75.5	70.5	S41
26	20491-36-20W	M36 × 2.0	32	20	O26.0 × 2.0	84.0	76.5	S41
27	20491-45-16T	M45 × 2.0	25	16	O32.0 × 2.0	75.5	73.5	S55
28	20491-45-20T	M45 × 2.0	32	20	O32.0 × 2.0	91.5	86.0	S55
29	20491-45-24W	M45 × 2.0	38	24	O32.0 × 2.0	98.0	88.5	S55
30	20491-52-20T	M52 × 2.0	32	20	O38.0 × 2.0	93.0	87.0	S60
31	20491-52-24T	M52 × 2.0	38	24	O38.0 × 2.0	106.5	98.0	S60

注：1表中代号用于编制软管
2如需用于缠绕软管代号改为20492-XX-XX

1后缀为空表示为收口螺帽
2后缀为T表示为套螺帽
3后缀为W表示为穿钢丝螺帽

标准软管接头 HOSE FITTING

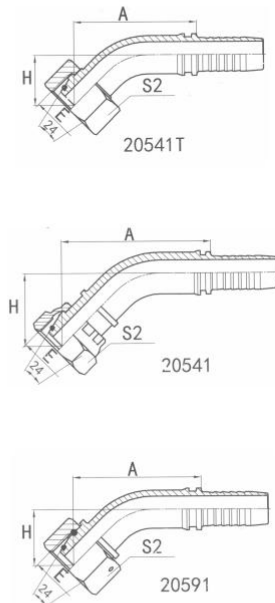

产品谱系20541 JL-8014 45° 公制内螺纹24° 锥带O形圈(重)

序号	产品代号 PART NO.	螺纹制式 THREAD E	胶管HOSE BORE		O形圈	尺寸DIMENSIONS		
			公称内径DN	标号DASH		A	H	S2
1	20541-14-04T	M14x1.5	6	04	O04.5X1.5	18.5	38.5	S17
2	20541-16-04T	M16x1.5	6	04	O06.5X1.5	18.5	40.5	S19
3	20541-16-05T	M16x1.5	8	05	O06.5X1.5	18.0	37.0	S19
4	20541-16-06	M16x1.5	10	06	O06.5X1.5	19.5	38.6	S22
5	20541-18-04T	M18x1.5	6	04	O08.0X1.5	21.5	43.5	S22
6	20541-18-05T	M18x1.5	8	05	O08.0X1.5	20.0	40.0	S22
7	20541-18-06T	M18x1.5	10	06	O08.0X1.5	22.0	47.0	S22
8	20541-20-05T	M20x1.5	8	05	O10.0X1.5	23.0	46.0	S24
9	20541-20-06T	M20x1.5	10	06	O10.0X1.5	23.5	48.0	S24
10	20541-20-08	M20x1.5	13	08	O10.0X1.5	23.5	48.5	S27
11	20541-22-06T	M22x1.5	10	06	O11.0X2.0	24.0	48.0	S27
12	20541-22-08T	M22x1.5	13	08	O11.0X2.0	25.5	61.0	S27
13	20541-24-06T	M24x1.5	10	06	O13.0X2.0	22.5	44.5	S30
14	20541-24-08T	M24x1.5	13	08	O13.0X2.0	26.0	61.0	S30
15	20541-24-10W	M24x1.5	16	10	O13.0X2.0	27.0	62.0	S30
16	20541-30-08T	M30x2.0	13	08	O16.3X2.4	28.0	65.0	S36
17	20541-30-10T	M30x2.0	16	10	O16.3X2.4	28.1	68.5	S36
18	20541-30-12T	M30x2.0	19	12	O16.3X2.4	29.0	74.0	S36
19	20541-36-12TS41	M36x2.0	19	12	O20.3X2.4	29.9	74.4	S41
20	20541-36-12T	M36x2.0	19	12	O20.3X2.4	29.9	74.4	S46
21	20541-36-16T	M36x2.0	25	16	O20.3X2.4	33.4	87.3	S41
22	20541-36-16TS46	M36x2.0	25	16	O20.3X2.4	33.4	87.3	S46
23	20541-42-16T	M42x2.0	25	16	O25.3X2.4	34.8	87.9	S50
24	20541-42-20W	M42x2.0	32	20	O25.3X2.4	40.1	100.9	S50
25	20541-52-20T	M52x2.0	32	20	O33.3X2.4	39.4	101.7	S60
26	20541-52-24T	M52x2.0	38	24	O33.3X2.4	42.5	119.0	S60

注：1表中代号用于编制软管
2如需用于缠绕软管代号改为20542-XX-XX
1后缀为空表示为收口螺帽
2后缀为T表示为套螺帽
3后缀为W表示为穿钢丝螺帽

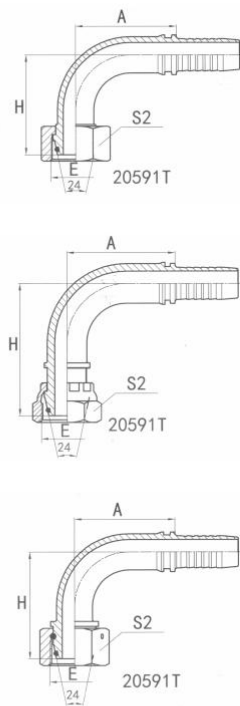

产品谱系20591 JL-8015 90° 公制内螺纹24° 锥带O形圈(重)

序号	产品代号 PART NO.	螺纹制式 THREAD E	胶管HOSE BORE		O形圈	尺寸DIMENSIONS		
			公称内径DN	标号DASH		A	H	S2
1	20591-14-04T	M14x1.5	6	04	O04.5X1.5	27.5	33.0	S17
2	20591-16-04T	M16x1.5	6	04	O06.5X1.5	27.5	34.0	S19
3	20591-16-05T	M16x1.5	8	05	O06.5X1.5	27.5	33.0	S19
4	20591-16-06	M16x1.5	10	06	O06.5X1.5	27.0	36.0	S22
5	20591-18-04T	M18x1.5	6	04	O08.0X1.5	30.0	38.0	S22
6	20591-18-05T	M18x1.5	8	05	O08.0X1.5	31.0	37.0	S22
7	20591-18-06T	M18x1.5	10	06	O08.0X1.5	33.0	38.0	S22
8	20591-20-05T	M20x1.5	8	05	O10.0X1.5	33.0	43.0	S24
9	20591-20-06T	M20x1.5	10	06	O10.0X1.5	35.0	44.0	S24
10	20591-20-08	M20x1.5	13	08	O10.0X1.5	37.5	45.0	S27
11	20591-22-06T	M22x1.5	10	06	O11.0X2.0	35.5	45.0	S27
12	20591-22-08T	M22x1.5	13	08	O11.0X2.0	42.0	49.0	S27
13	20591-24-06T	M24x1.5	10	06	O13.0X2.0	32.5	42.5	S30
14	20591-24-08T	M24x1.5	13	08	O13.0X2.0	40.0	50.5	S30
15	20591-24-10W	M24x1.5	16	10	O13.0X2.0	43.5	52.0	S30
16	20591-30-08T	M30x2.0	13	08	O16.3X2.4	41.0	53.5	S36
17	20591-30-10T	M30x2.0	16	10	O16.3X2.4	54.0	56.5	S36
18	20591-30-12T	M30x2.0	19	12	O16.3X2.4	61.0	62.0	S36
19	20591-36-12TS41	M36x2.0	19	12	O20.3X2.4	61.0	62.5	S41
20	20591-36-12T	M36x2.0	19	12	O20.3X2.4	61.0	62.5	S46
21	20591-36-16T	M36x2.0	25	16	O20.3X2.4	67.0	62.0	S41
22	20591-36-16TS46	M36x2.0	25	16	O20.3X2.4	67.0	62.0	S46
23	20591-42-16T	M42x2.0	25	16	O25.3X2.4	76.5	74.0	S50
24	20591-42-20W	M42x2.0	32	20	O25.3X2.4	91.0	87.0	S50
25	20591-52-20T	M52x2.0	32	20	O33.3X2.4	93.0	86.5	S60
26	20591-52-24T	M52x2.0	38	24	O33.3X2.4	106.5	97.0	S60

注：1表中代号用于编制软管
2如需用于缠绕软管代号改为20592-XX-XX
1后缀为空表示为收口螺帽
2后缀为T表示为套螺帽
3后缀为W表示为穿钢丝螺帽

标准软管接头 HOSE FITTING

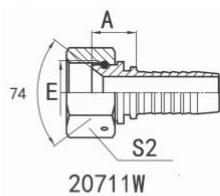
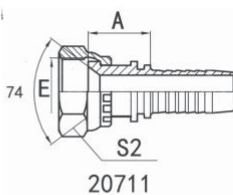
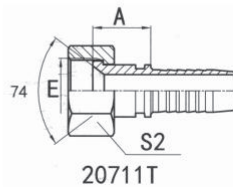

产品谱系20711

JL-8016

公制内螺纹74° 内锥面

序号	产品代号 PART NO.	螺纹制式 THREAD E	胶管HOSE BORE		尺寸DIMENSIONS		
			公称内径DN	标号DASH	A	S2	
1	20711-12-04	M12x1.5	6	04	14.5		S17
2	20711-14-04T	M14x1.5	6	04	16.5		S17
3	20711-16-04T	M16x1.5	6	04	16.5		S19
4	20711-16-05T	M16x1.5	8	05	17.0		S19
5	20711-16-06	M16x1.5	10	06	16.5		S22
6	20711-18-05T	M18x1.5	8	05	15.0		S22
7	20711-18-06T	M18x1.5	10	06	18.0		S22
8	20711-22-06T	M22x1.5	10	06	16.0		S27
9	20711-22-08T	M22x1.5	13	08	19.5		S27
10	20711-27-08T	M27x1.5	13	08	18.5		S32
11	20711-27-10T	M27x1.5	16	10	19.5		S32
12	20711-30-10T	M30x1.5	16	10	18.0		S36
13	20711-30-12T	M30x1.5	19	12	23.5		S36
14	20711-36-12T	M36x1.5	19	12	20.0		S41
15	20711-36-16T	M36x1.5	25	16	24.0		S41
16	20711-39-16T	M39x1.5	25	16	23.5		S46
17	20711-42-16T	M42x1.5	25	16	23.5		S50
18	20711-42-20W	M42x1.5	32	20	25.0		S50
19	20711-45-16T	M45x1.5	25	16	24.0		S55
20	20711-45-20T	M45x1.5	32	20	25.0		S55
21	20711-52-20T	M52x1.5	32	20	25.0		S60
22	20711-52-24T	M52x1.5	38	24	25.0		S60
23	20711-64-32T	M64x1.5	51	32	26.0		S75

注：1表中代号用于编制软管

2如需用于缠绕软管代号改为20712-XX-XX

1后缀为空表示为收口螺帽

2后缀为T表示为套螺帽

3后缀为W表示为穿钢丝螺帽

产品谱系22691

JL-8017

90° 英制内螺纹60° 外锥面

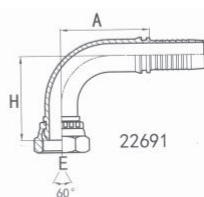
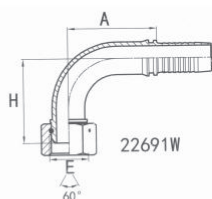

序号	产品代号 PART NO.	螺纹制式 THREAD E	胶管HOSE BORE		尺寸DIMENSIONS		
			公称内径DN	标号DASH	A	H	S2
1	22691-04-04	G1/4" x19	6	04	30.0	36.5	S19
2	22691-04-05	G1/4" x19	8	05	27.0	32.5	S19
3	22691-06-04	G3/8" x19	6	04	30.0	37.5	S22
4	22691-06-06	G3/8" x19	10	06	35.5	43.0	S22
5	22691-06-08	G3/8" x19	13	08	36.5	44.0	S22
6	22691-08-06	G1/2" x14	10	06	35.5	46.0	S27
7	22691-08-08	G1/2" x14	13	08	41.0	51.0	S27
8	22691-10-08	G5/8" x14	13	08	41.0	51.0	S30
9	22691-10-10	G5/8" x14	16	10	55.0	55.0	S30
10	22691-12-10	G3/4" x14	16	10	55.0	55.0	S32
11	22691-12-12	G3/4" x14	19	12	61.0	60.1	S32
12	22691-16-16W	G1" x11	25	16	76.5	72.5	S41
13	22691-20-20W	G1.1/4" x11	32	20	91.5	84.5	S50
14	22691-24-24W	G1.1/2" x11	38	24	106.4	100.0	S55
15	22691-32-32W	G2" x11	51	32	131.8	123.3	S70

注：1表中代号用于编制软管

2如需用于缠绕软管代号改为22692-XX-XX

1后缀为空表示为收口螺帽

2后缀为T表示为套螺帽

3后缀为W表示为穿钢丝螺帽

标准软管接头 HOSE FITTING

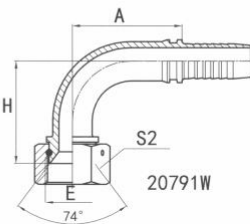
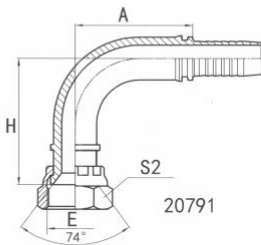
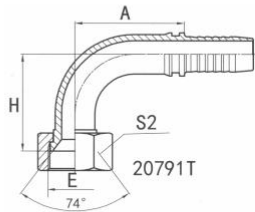

产品谱系20791

JL-8018

公制内螺纹74° 内锥面

序号	产品代号 PART NO.	螺纹制式 THREAD E	胶管HOSE BORE		尺寸DIMENSIONS		
			公称内径DN	标号DASH	A	H	S2
1	20791-12-04	M12x1.5	6	04	30.0	33.5	S17
2	20791-14-04T	M14x1.5	6	04	28.4	30.0	S17
3	20791-16-04T	M16x1.5	6	04	30.0	34.5	S19
4	20791-16-05T	M16x1.5	8	05	33.8	38.0	S19
5	20791-16-06	M16x1.5	10	06	35.5	40.0	S22
6	20791-18-05T	M18x1.5	8	05	34.0	37.5	S22
7	20791-18-06T	M18x1.5	10	06	35.3	40.0	S22
8	20791-22-06T	M22x1.5	10	06	35.0	39.0	S27
9	20791-22-08T	M22x1.5	13	08	41.8	44.0	S27
10	20791-27-08T	M27x1.5	13	08	41.8	45.0	S32
11	20791-27-10T	M27x1.5	16	10	54.0	49.5	S32
12	20791-30-10T	M30x1.5	16	10	54.0	50.0	S36
13	20791-30-12T	M30x1.5	19	12	61.0	57.0	S36
14	20791-36-12T	M36x1.5	19	12	61.0	55.0	S41
15	20791-36-16T	M36x1.5	25	16	74.2	66.0	S41
16	20791-39-16T	M39x1.5	25	16	76.5	67.0	S46
17	20791-42-16T	M42x1.5	25	16	76.5	67.0	S50
18	20791-42-20W	M42x1.5	32	20	91.5	80.0	S50
19	20791-45-16T	M45x1.5	25	16	76.5	68.0	S55
20	20791-45-20T	M45x1.5	32	20	91.5	79.5	S55
21	20791-52-20T	M52x1.5	32	20	91.5	79.0	S60
22	20791-52-24T	M52x1.5	38	24	106.4	95.	S60
23	20791-64-32T	M64x1.5	51	32	131.0	116.3	S75

注：1表中代号用于编制软管
2如需用于缠绕软管代号改为20792-XX-XX

1后缀为空表示为收口螺帽
2后缀为T表示为套螺帽
3后缀为W表示为穿钢丝螺帽

产品谱系22611

JL-8019

英制内螺纹60° 外锥面

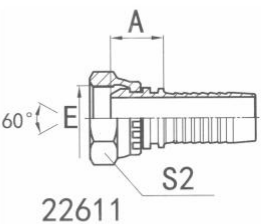
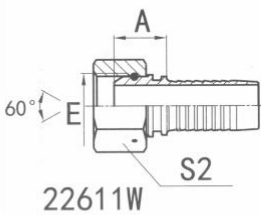

序号	产品代号 PART NO.	螺纹制式 THREAD E	胶管HOSE BORE		尺寸DIMENSIONS		
			公称内径DN	标号DASH	A	H	S2
1	22611-04-04	G1/4" x19	6	04	#	18.0	S19
2	22611-04-05	G1/4" x19	8	05	#	18.0	S19
3	22611-06-04	G3/8" x19	6	04	#	19.0	S22
4	22611-06-06	G3/8" x19	10	06	#	19.5	S22
5	22611-06-08	G3/8" x19	13	08	#	19.5	S22
6	22611-08-06	G1/2" x14	10	06	#	21.0	S27
7	22611-08-08	G1/2" x14	13	08	#	21.5	S27
8	22611-10-08	G5/8" x14	13	08	#	22.0	S30
9	22611-10-10	G5/8" x14	16	10	#	23.0	S30
10	22611-12-10	G3/4" x14	16	10	#	23.5	S32
11	22611-12-12	G3/4" x14	19	12	#	24.0	S32
12	22611-16-16W	G1" x11	25	16	#	27.0	S41
13	22611-20-20W	G1.1/4" x11	32	20	#	30.5	S50
14	22611-24-24W	G1.1/2" x11	38	24	#	32.0	S55
15	22611-32-32W	G2" x11	51	32	#	31.0	S70

注：1表中代号用于编制软管
2如需用于缠绕软管代号改为22612-XX-XX

1后缀为空表示为收口螺帽
2后缀为T表示为套螺帽
3后缀为W表示为穿钢丝螺帽

标准软管接头 HOSE FITTING

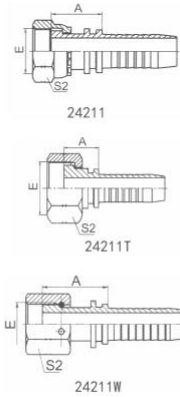

产品谱系24211		JL-8020		美制ORFS内螺纹平面			
序号	产品代号 PART NO.	螺纹制式 THREAD E	胶管HOSE BORE		尺寸DIMENSIONS		
			公称内径DN	标号DASH	A		S2
1	24211-04-04	9/16" x18	6	04	22.5		S19
2	24211-06-06	11/16" x16	10	06	25.5		S22
3	24211-08-08	13/16" x16	13	08	28.0		S27
4	24211-10-10	1" x14	16	10	33.0		S30
5	24211-12-12T	1.3/16" x12	19	12	28.0		S36
6	24211-16-12T	1.7/16" x12	19	12	35.0		S41
7	24211-16-16T	1.7/16" x12	25	16	34.5		S41
8	24211-20-20W	1.11/16" x12	32	20	42.5		S50

注：1表中代号用于编制软管
2如需用于缠绕软管代号改为24212-XX-XX

1后缀为空表示为收口螺帽
2后缀为T表示为套螺帽
3后缀为W表示为穿钢丝螺帽

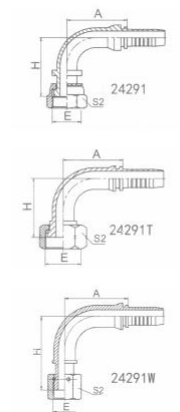

产品谱系24291		JL-8021		90° 美制ORFS内螺纹平面			
序号	产品代号 PART NO.	螺纹制式 THREAD E	胶管HOSE BORE		尺寸DIMENSIONS		
			公称内径DN	标号DASH	A	H	S2
1	24291-04-04	9/16" x18	6	04	30.0	24.0	S19
2	24291-06-06	11/16" x16	10	06	34.5	30.0	S22
3	24291-08-08	13/16" x16	13	08	40.6	38.7	S27
4	24291-10-10	1" x14	16	10	54.0	43.0	S30
5	24291-12-12T	1.3/16" x12	19	12	61.3	54.0	S36
6	24291-16-12T	1.7/16" x12	19	12	61.3	56.0	S41
7	24291-16-16T	1.7/16" x12	25	16	75.5	66.0	S41
8	24291-20-20W	1.11/16" x12	32	20	93.0	85.0	S50

注：1表中代号用于编制软管
2如需用于缠绕软管代号改为24292-XX-XX

1后缀为空表示为收口螺帽
2后缀为T表示为套螺帽
3后缀为W表示为穿钢丝螺帽

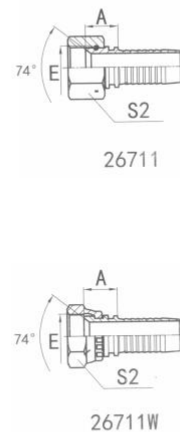

产品谱系26711		JL-8022		美制JIC内螺纹74° 内锥面			
序号	产品代号 PART NO.	螺纹制式 THREAD E	胶管HOSE BORE		尺寸DIMENSIONS		
			公称内径DN	标号DASH	A		S2
1	26711-04-04	7/16" x20	6	04	15.0		S15
2	26711-04-05	7/16" x20	8	05	14.5		S15
3	26711-04-06	7/16" x20	10	06	14.5		S15
4	26711-06-06	9/16" x18	10	06	15.5		S19
5	26711-06-08	9/16" x18	13	08	16.0		S19
6	26711-08-06	3/4" x16	10	06	17.5		S24
7	26711-08-08	3/4" x16	13	08	18.5		S24
8	26711-08-10	3/4" x16	16	10	19.0		S24
9	26711-10-08	7/8" x14	13	08	19.0		S27
10	26711-10-10	7/8" x14	16	10	19.5		S27
11	26711-12-10	1.1/16" x12	16	10	21.0		S32
12	26711-12-12	1.1/16" x12	19	12	21.5		S32
13	26711-16-12W	1.5/16" x12	19	12	25.5		S41
14	26711-16-16W	1.5/16" x12	25	16	26.5		S41
15	26711-20-20W	1.5/8" x12	32	20	25.0		S50
16	26711-24-20W	1.7/8" x12	32	20	27.0		S55
17	26711-24-24W	1.7/8" x12	38	24	30.0		S55
18	26711-32-24T	2.1/2" x12	38	24	29.0		S75
19	26711-32-32T	2.1/2" x12	51	32	27.0		S75

注：1表中代号用于编制软管
2如需用于缠绕软管代号改为26712-XX-XX

1后缀为空表示为收口螺帽
2后缀为T表示为套螺帽
3后缀为W表示为穿钢丝螺帽

标准软管接头 HOSE FITTING

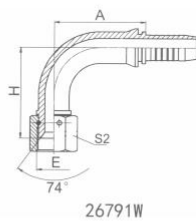
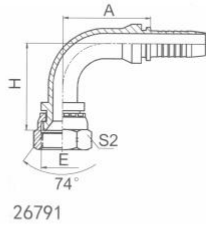

产品谱系26791 JL-8023 90° 美制JIC内螺纹74° 内锥面

序号	产品代号 PART NO.	螺纹制式 THREAD E	胶管HOSE BORE		尺寸DIMENSIONS		
			公称内径DN	标号DASH	A	H	S2
1	26791-04-04	7/16" x20	6	04	30.0	33.5	S15
2	26791-04-05	7/16" x20	8	05	30.0	33.5	S15
3	26791-04-06	7/16" x20	10	06	30.0	33.5	S15
4	26791-06-06	9/16" x18	10	06	35.3	39.3	S19
5	26791-06-08	9/16" x18	13	08	35.8	39.3	S19
6	26791-08-06	3/4" x16	10	06	35.3	41.3	S24
7	26791-08-08	3/4" x16	13	08	41.0	47.5	S24
8	26791-08-10	3/4" x16	16	10	42.5	47.5	S24
9	26791-10-08	7/8" x14	13	08	41.0	48.0	S27
10	26791-10-10	7/8" x14	16	10	54.0	51.0	S27
11	26791-12-10	1.1/16" x12	16	10	54.0	52.5	S32
12	26791-12-12	1.1/16" x12	19	12	61.0	57.5	S32
13	26791-16-12W	1.5/16" x12	19	12	61.0	61.5	S41
14	26791-16-16W	1.5/16" x12	25	16	76.5	70.0	S41
15	26791-20-20W	1.5/8" x12	32	20	80.5	91.5	S50
16	26791-24-20W	1.7/8" x12	32	20	80.5	91.5	S55
17	26791-24-24W	1.7/8" x12	38	24	106.4	98	S55
18	26791-32-24W	2.1/2" x12	38	24	106.4	103	S75
19	26791-32-32W	2.1/2" x12	51	32	133.1	121.75	S75

注：1表中代号用于编制软管
2如需用于缠绕软管代号改为26792-XX-XX

1后缀为空表示为收口螺帽
2后缀为T表示为套螺帽
3后缀为W表示为穿钢丝螺帽

产品谱系29611 JL-8024 日本英制内螺纹60° 内锥面

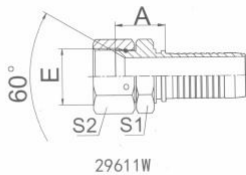
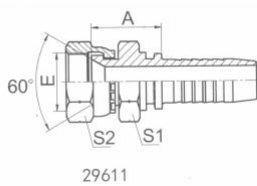

序号	产品代号 PART NO.	螺纹E THREAD E	胶管HOSE BORE		尺寸DIMENSIONS			
			公称内径DN	标号DASH	A	#	S1	S2
1	29611-04-04	G1/4" x19	6	04	21.0	#	S19	S19
2	29611-04-05	G1/4" x19	8	05	21.0	#	S19	S19
3	29611-04-06	G1/4" x19	10	06	21.0	#	S19	S19
4	29611-06-04	G3/8" x19	6	04	23.0	#	S22	S22
5	29611-06-05	G3/8" x19	8	05	23.0	#	S22	S22
6	29611-06-06	G3/8" x19	10	06	23.0	#	S22	S22
7	29611-08-06	G1/2" x14	10	06	28.0	#	S27	S27
8	29611-08-08	G1/2" x14	13	08	26.5	#	S27	S27
9	29611-10-08	G5/8" x14	13	08	29.5	#	S30	S30
10	29611-10-10	G5/8" x14	16	10	30.5	#	S30	S30
11	29611-12-10	G3/4" x14	16	10	30.0	#	S32	S32
12	29611-12-12	G3/4" x14	19	12	30.5	#	S32	S32
13	29611-16-16	G1" x11	25	16	32.0	#	S41	S41
14	29611-20-20W	G1.1/4" x11	32	20	43.0	#	S50	S50
15	29611-24-24W	G1.1/2" x11	38	24	43.5	#	S55	S55
16	29611-32-32W	G2" x11	51	32	46.5	#	S70	S70

注：1表中代号用于编制软管
2如需用于缠绕软管代号改为29612-XX-XX

1后缀为空表示为收口螺帽
2后缀为T表示为套螺帽
3后缀为W表示为穿钢丝螺帽

尼龙管系列 Nylon tube

PU管
PU Tube

JL-9001



尼龙管
Nylon Tube

JL-9002



尼龙管NylonTube

规格 Size	外径 O.D. (mm)	内径 I.D. (mm)	工作压力 Working pressure Mpa	爆破压力 Bursting pressure Mpa	弯曲半径 Bending radius (mm)	规格 Size	外径 O.D. (mm)	内径 I.D. (mm)	工作压力 Working pressure Mpa	爆破压力 Bursting pressure Mpa	弯曲半径 Bending radius (mm)
Φ4×0.75	4	2.5	3.1	7.54	20	Φ10×12	10	6	3.4	8.62	60
Φ4×1	4	2	4.5	11.25	20	Φ11×1.5	11	8	2.1	5.51	60
Φ5×1	5	3	3.4	8.57	25	Φ12×1.25	12	9.5	1.6	4.06	60
Φ6×0.5	6	5	1.2	2.80	30	Φ12×1.5	12	9	1.9	5	60
Φ6×0.75	6	4.5	1.9	4.77	30	Φ12×2	12	8	2.7	6.96	60
Φ6×1	6	4	2.7	6.92	30	Φ12.5×1.25	12.5	10	1.5	3.89	60
Φ6×1.5	6	3	4.4	11.36	30	Φ12.5×1.5	12.5	9.5	1.8	4.4	60
Φ6.5×1.25	6.5	4	3.1	8.30	30	Φ12.5×1.7	12.5	9.1	2	5.59	60
Φ6×2	6	2	6.7	16.74	30	Φ14×1.5	14	11	1.6	4.22	75
Φ6.5×1	6.5	4.5	2.4	6.40	30	Φ14×2	14	10	2.2	5.83	75
Φ8×1	8	6	1.9	5.00	40	Φ15×1	15	13	1	2.53	90
Φ7×1	7	5	2.2	5.90	40	Φ15×1.5	15	12	1.5	3.92	90
Φ8×1.25	8	5.5	2.5	6.42	40	Φ16×1.5	16	13	1.2	3.65	100
Φ8×1.5	8	5	3.1	8.00	40	Φ16×2	16	12	1.9	5	100
Φ8.7×1	8.7	6.7	1.52	4.60	40	Φ18×1.5	18	15	1.2	3.21	100
Φ8×2	8	4	4.5	11.43	40	Φ18×2	18	14	1.7	4.4	100
Φ9×1.5	9	6	2.7	6.92	40	Φ20×2	20	16	1.5	3.92	
Φ10×1	10	8	1.5	3.91	60	Φ22×2	22	18	1.34	3.54	
Φ10×1.25	10	7.5	1.9	4.98	60						

弹簧软管系列 Spring hose

PU弹簧管

Pu spring air hose

JL-9003



PA弹簧管

Pa spring air hose

JL-9004



Seven-way ABS coiled cable

JL-9005



Seven-way ABS coiled cable

JL-9006



Seven-way ABS coiled cable

JL-9007



Seven-way ABS coiled cable

JL-9008





诸暨市金鲁橡塑制品有限公司

ZHUJI JINLU RUBBER&PLASTIC PRODUCTS CO.,LTD.





诸暨市金鲁橡塑制品有限公司
ZHUJI JINLU RUBBER&PLASTIC PRODUCTS CO.,LTD.

Workshop





诸暨市金鲁橡塑制品有限公司
ZHUJI JINLU RUBBER&PLASTIC PRODUCTS CO.,LTD.

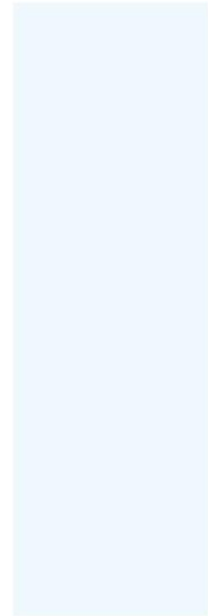

B
Brand concept
品牌理念

做大，做强，做精，做高

Make it big; Make it strong; Make it accurate; Make it high

做大：以规模和占有市场率为指标

Make it big: as scale and market share for the indicator

做强：管理+服务+多元化发展自己

Make it strong: management + service + diversified development

做精：专业；专注

Make it accurate: professional; dedicated

做高：建筑人才集合高地

Make it high: construct talent highland



C 公司简介 Company Profile

诸暨市金鲁橡塑制品有限公司坐落于诸永高速直埠出口直埠工业区，占地6000多平方米，共拥有技术人员、管理人员、操作工人100多名，是一家勤于思考、勇于创新的企业。

金鲁拥有来自德国等地的先进工艺流水线，通过了ISO: 9001-2000国际质量体系认证。在多年的生产经营中，金鲁不断将创新成果融入产品，完善产品体系，提升产品科技质量。今天，金鲁已经建立了多样化的产品体系，产品种类涵盖气动产品、液压产品、五金接头、汽车配件、各类工具修理盒五大系列一千多个品种。产品远销亚洲、中东、澳洲、欧美、南非等地区，为多个厂商配套，在客户群中拥有良好的口碑。

金鲁的信念是质量第一、信誉第一、客户至上；用一流的质量，二流的价格，全方位的服务，为客户最大限度创造价值，成为全国汽配领域的品牌制造商。

Zhuji JinLu rubber&plastic products Co., LTD is located in the Zhuyong high-speed Zhubu for export,Zhibu industrial zone.Covers an area of more than 6000 square meters.It has more than 100 technical personnel, management personnel and operating workers.It is a hard thinking and innovative enterprises.

JinLu has advanced process lines from Germany and other places.Passed the ISO9001-2000 international quality system certification.In many years of production and management JinLu constantly pioneered achievements into products;improved the product system products' quality and technology.Now JinLu has established a diversified product system.The products have five series including automatic products;hydraulic products;hardware fitting;auto parts and types of repair kit more than 1,000 varieties.

JinLu supported for multiple vendors and exported to Asia, the Middle East, Australia, Europe,United States, South Africa and other regions.Now JinLu has a good reputation in the customer base.

Quality first, reputation first, customers first are JinLu belief.It creates maximum value for customers with first-class quality, second-rate prices and full range of services.In the future Jinlu will be become a national brand manufacturers in the field of auto parts.

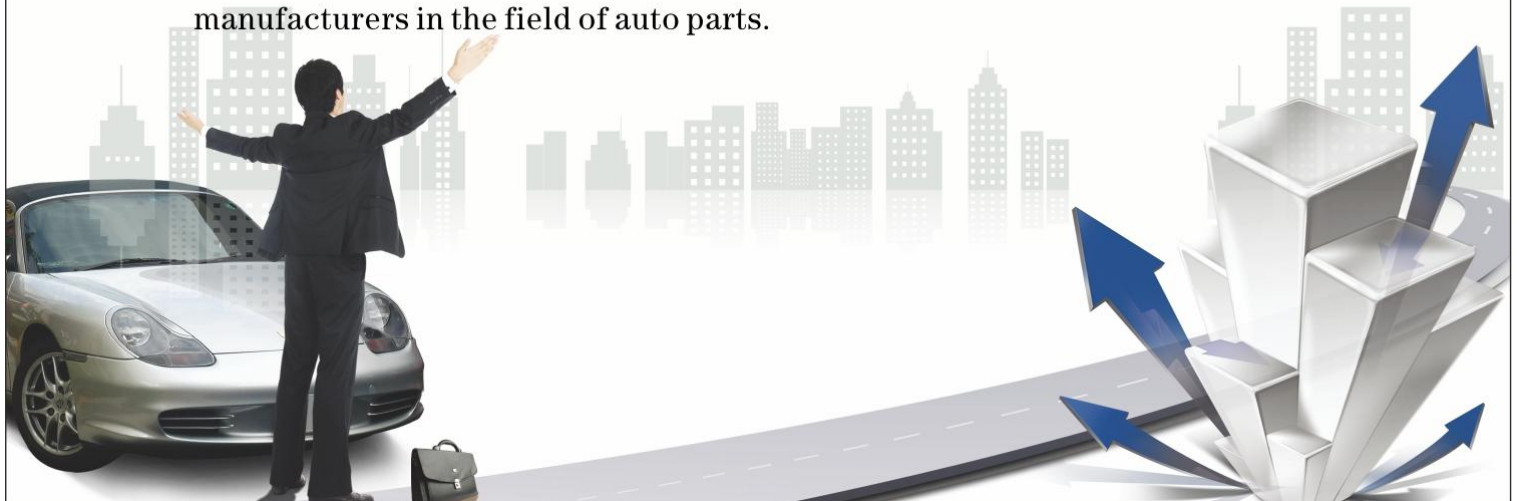

专业品质 值得信赖



2018.11



地址 (Add): 浙江省诸暨市直埠工业区
电话(Tel): 0086-575-87626817
传真(Fax): 0086-575-87626396
E-mail: yao@jinlurubber.com
Http://www.jinlurubber.cn
Http://www.jinlurubber.com



诸暨市金鲁橡塑制品有限公司
ZHUJI JINLU RUBBER&PLASTIC PRODUCTS CO.,LTD.